

PARTITION ASSEMBLY INSTRUCTIONS

Models
NEX223MMP and NEX224MMP

 *Before discarding the packaging, inventory the components and fasteners. (Some may be taped to the foam packaging.)*

FASTENERS AND HARDWARE

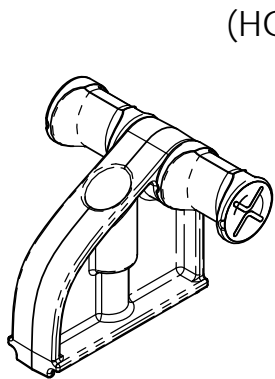

TABLET HANGER
2 EA.

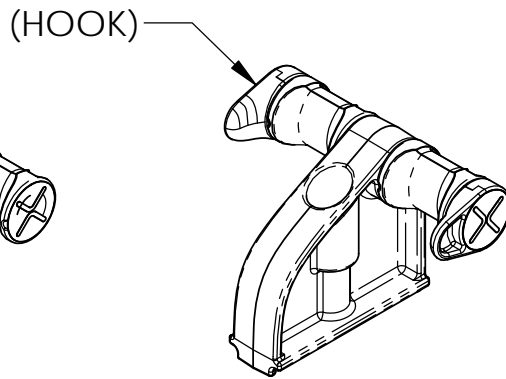

TABLET HANGER
(WITH HOOKS)
2 EA.

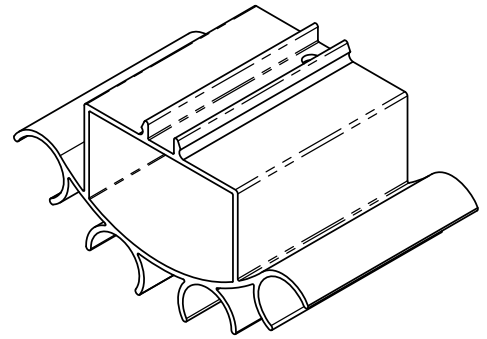

MARKER/ERASER
HOLDER
1 EA.

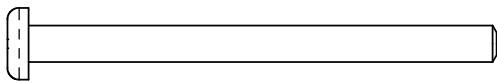

#10 X 2 1/2" PAN HEAD
MACHINE SCREW
5 EA.

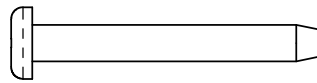

#10 X 1 1/2" PAN HEAD
MACHINE SCREW
2 EA.
(NEX224MP ONLY)

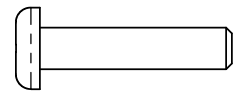

#12 X 1" PAN HEAD
MACHINE SCREW
8 EA.

RECOMMENDED TOOLS:

CORDLESS DRILL - 12 VOLT OR BETTER

#2 AND #3 PHILLIPS SCREWDRIVER BITS

SCREWDRIVER BIT EXTENDER

PARTITION COMPONENTS

(NEX224MP SHOWN)

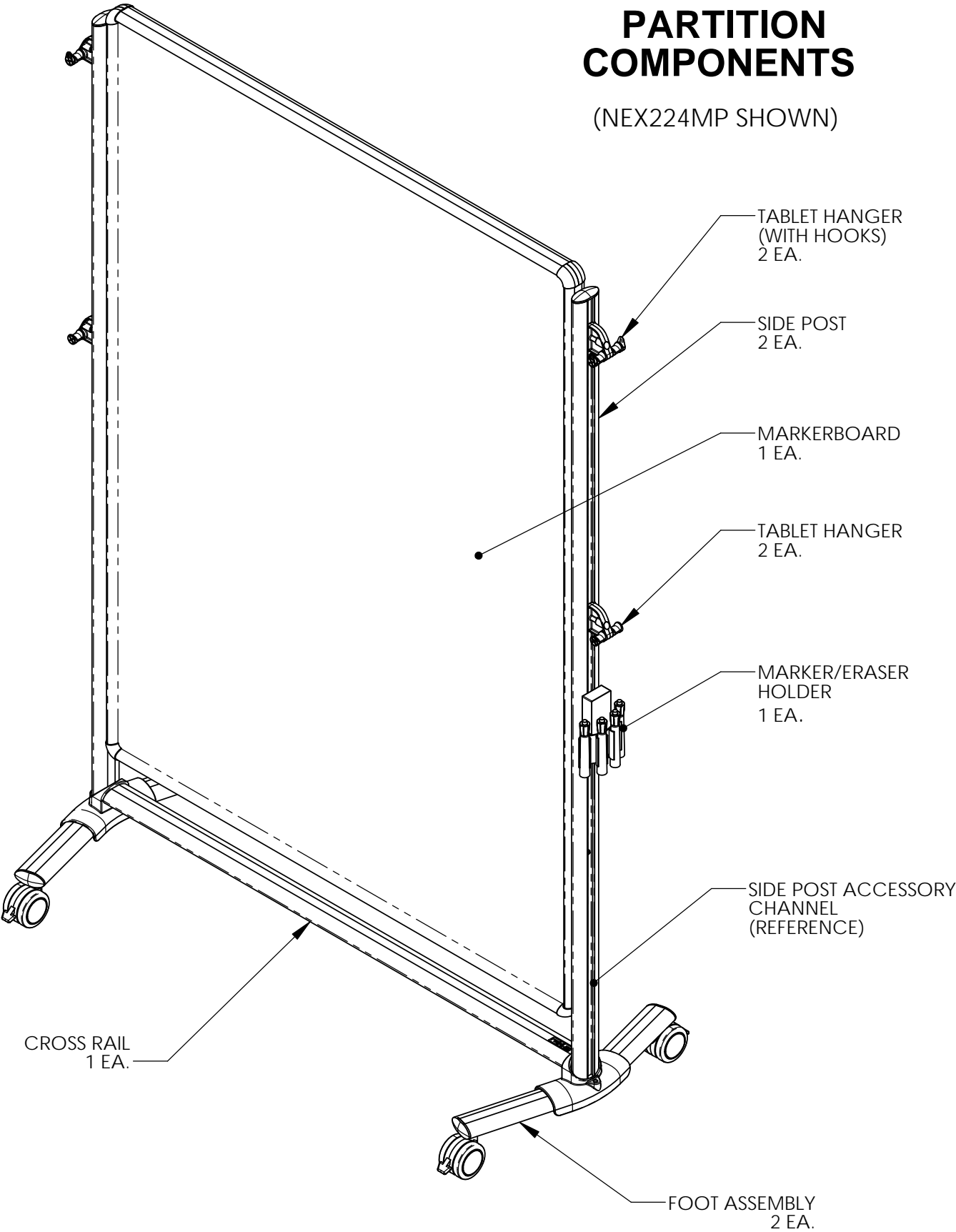

1 • Loosely attach the markerboard and the accent panel, with rails, to the side posts as shown.

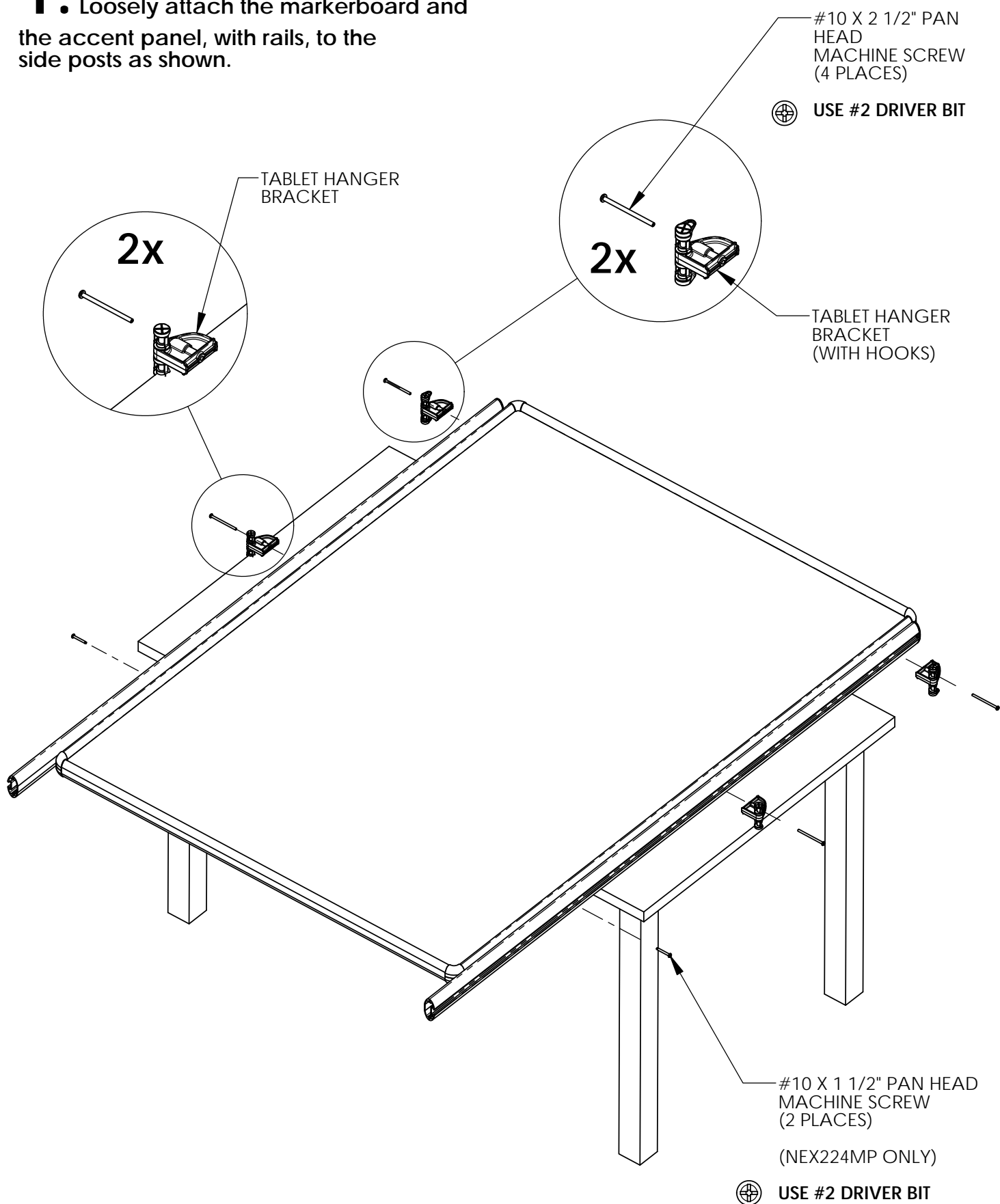

2. Attach the foot assemblies to the cross rail, as shown.

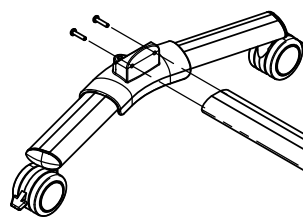

INSTALL WITH
CHANNEL SIDE FACING
DOWN

ASSEMBLE THE FEET ASSEMBLY ON A
FLAT SURFACE, SO THAT THE CASTERS STAY LEVEL.

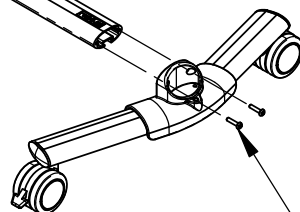

#12 X 1" PAN HEAD
MACHINE SCREW
(4 PLACES)

USE #3 DRIVER BIT
WITH A BIT EXTENSION

3. Attach the feet assembly to
the side posts, as shown.

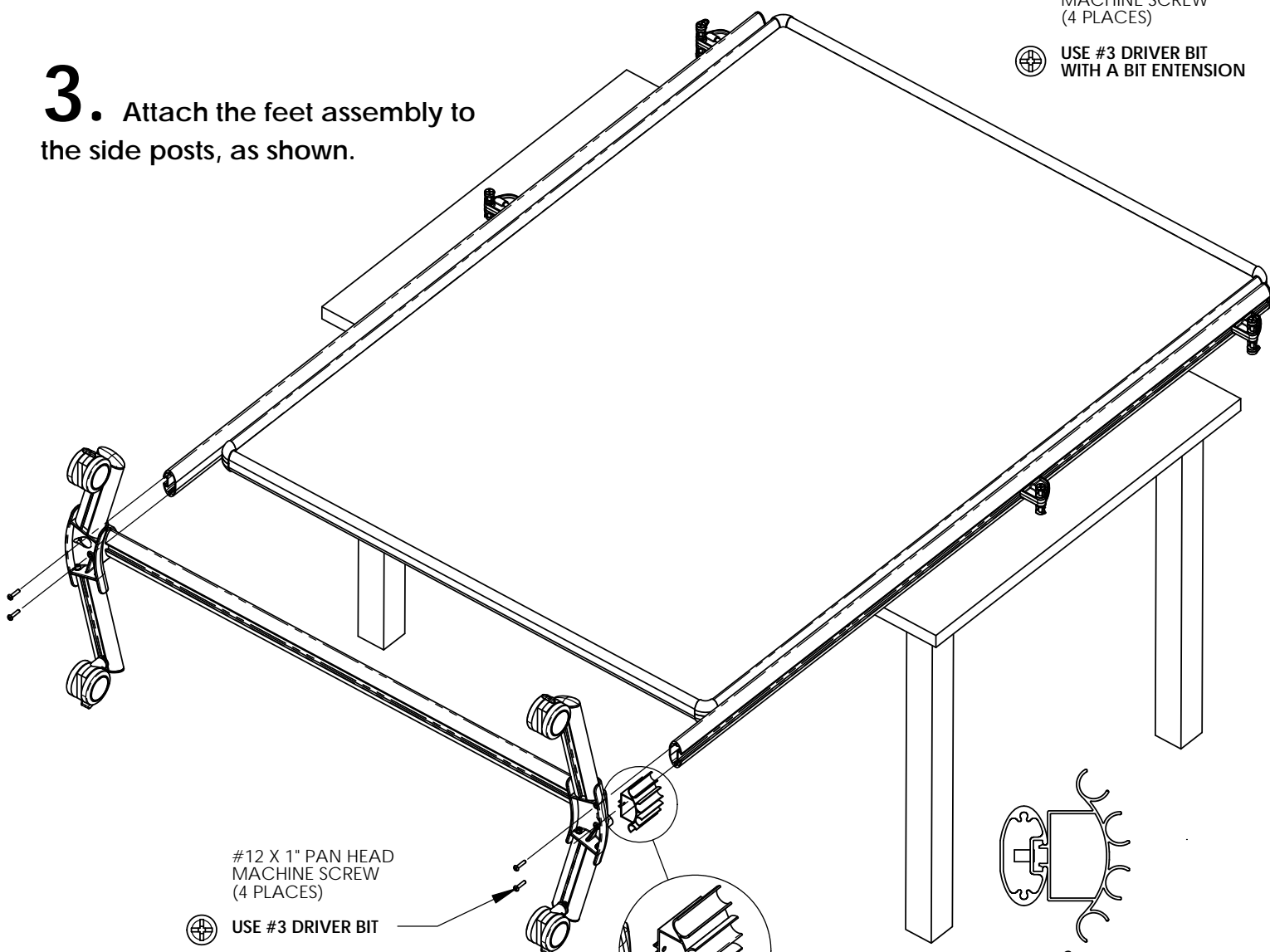

#12 X 1" PAN HEAD
MACHINE SCREW
(4 PLACES)

USE #3 DRIVER BIT

HOLE
ORIENTATION

SLIDE THE MARKER/ERASER
HOLDER INTO THE SIDE POST
ACCESSORY CHANNEL BEFORE
ATTACHING THE FEET ASSEMBLY.

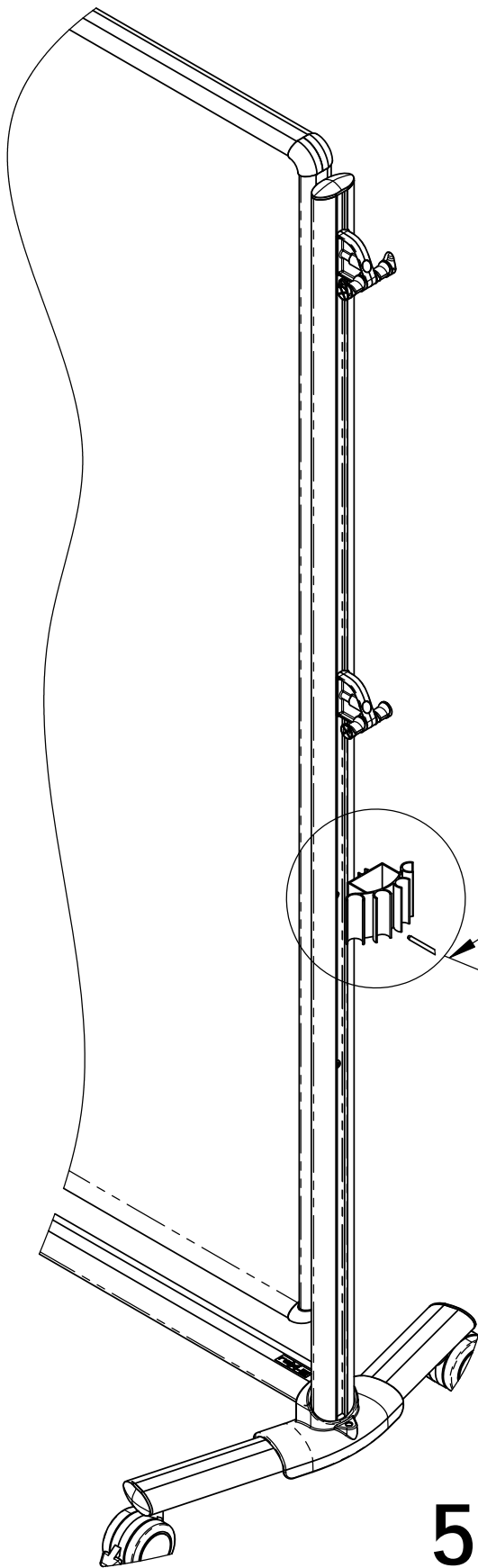

- 4.** Slide the marker/eraser holder up into position below the lower tablet hanger and attach with the screw as shown.

#10 X 2 1/2" PAN HEAD
MACHINE SCREW



USE #2 DRIVER BIT

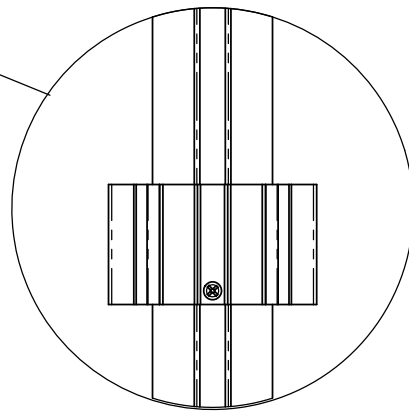

- 5.** Tighten all screws to complete the assembly.