

## EASEL AND IDEAWALL ASSEMBLY INSTRUCTIONS

### Models

NEX203ME-CM, NEX203ME-EM,  
NEX203ME-PM, NEX203ME-SM,  
NEX206MW-CM, NEX206MW-EM,  
NEX206MW-PM, NEX206MW-SM

 *Before discarding the packaging, inventory the components and fasteners. (Some may be taped to the foam packaging.)*

## FASTENERS AND HARDWARE

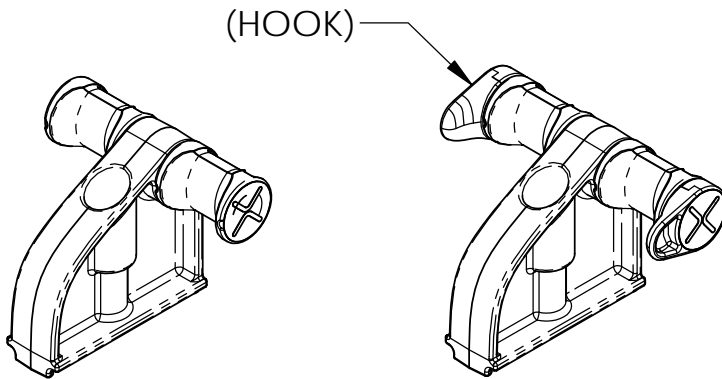

TABLET HANGER  
2 EA.

TABLET HANGER  
(WITH HOOKS)  
2 EA.

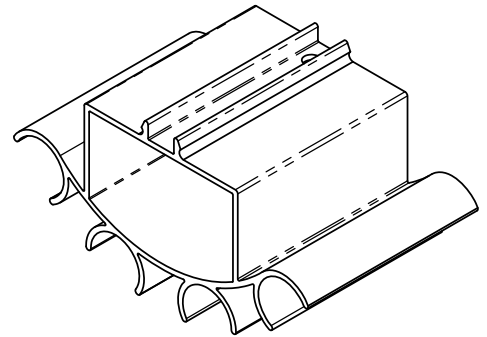

MARKER/ERASER  
HOLDER  
1 EA.

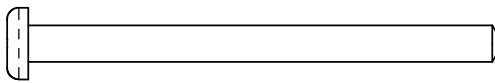

#10 X 2 1/2" PAN HEAD  
MACHINE SCREW  
5 EA.

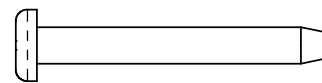

#10 X 1 1/2" PAN HEAD  
TAPPING SCREW  
4 EA.

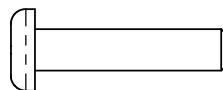

#12 X 1" PAN HEAD  
MACHINE SCREW  
8 EA.

## RECOMMENDED TOOLS:

CORDLESS DRILL - 12 VOLT OR BETTER

#2 AND #3 PHILLIPS SCREWDRIVER BITS

SCREWDRIVER BIT EXTENDER

# EASEL AND IDEAWALL COMPONENTS

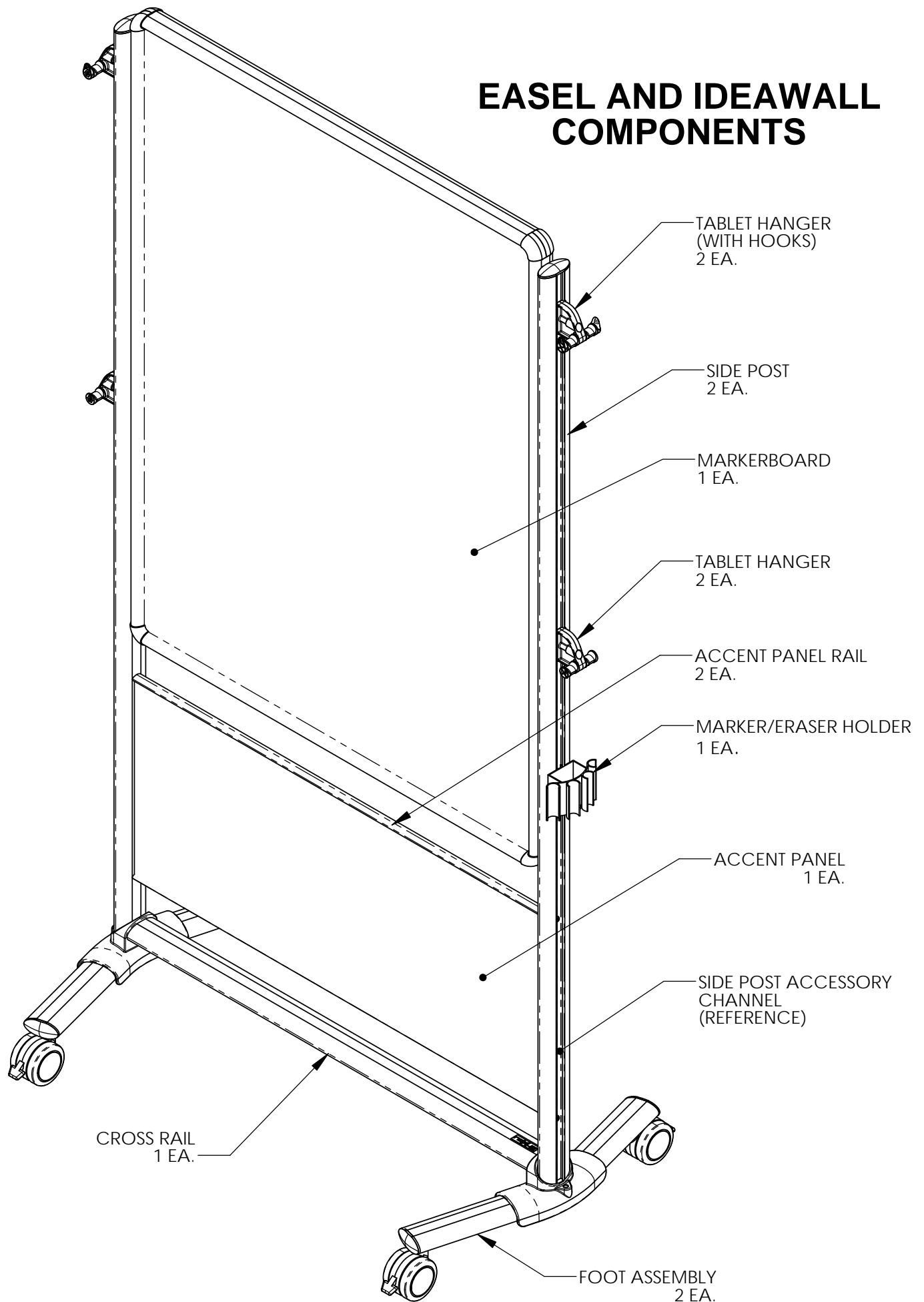

**1.** Insert the accent panel into the accent panel rails.

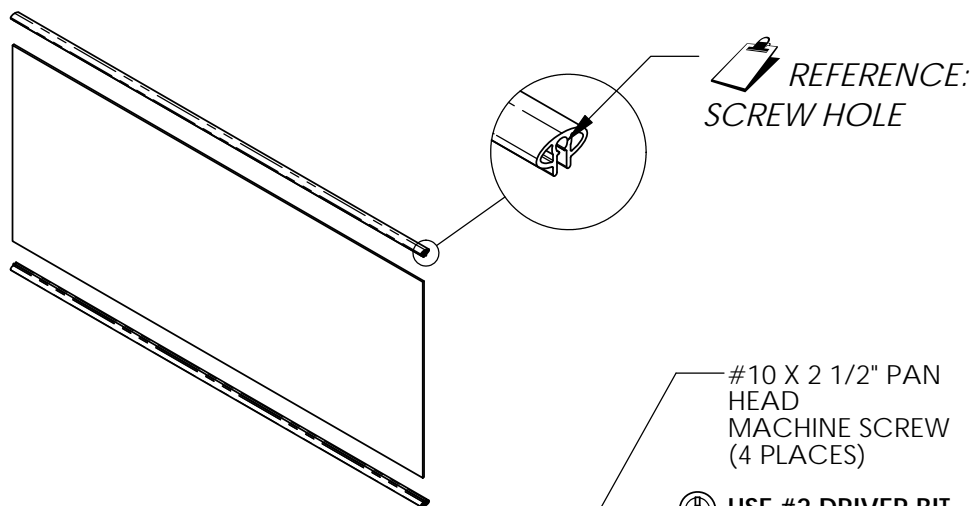

**2.** Loosely attach the markerboard and the accent panel, with rails, to the side posts as shown.

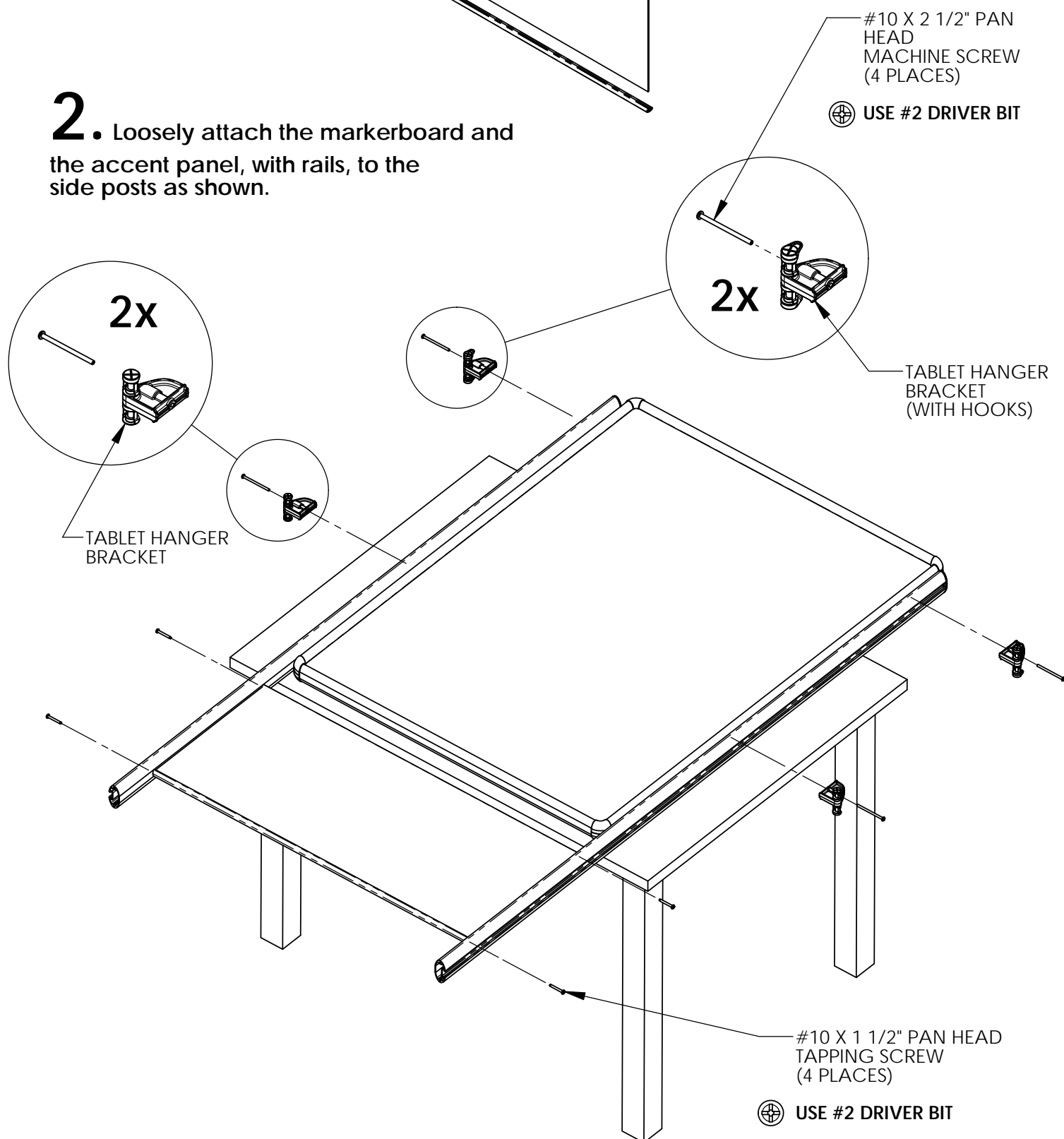

### 3. Attach the foot assemblies to the cross rail, as shown.

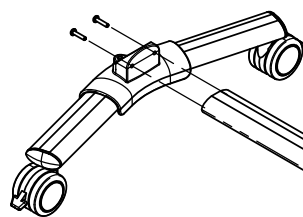

INSTALL WITH  
CHANNEL SIDE FACING  
DOWN

ASSEMBLE THE FEET ASSEMBLY ON A  
FLAT SURFACE, SO THAT THE CASTERS STAY LEVEL.

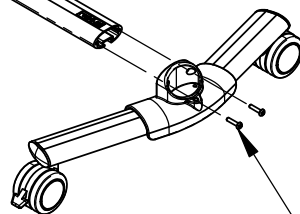

#12 X 1" PAN HEAD  
MACHINE SCREW  
(4 PLACES)

USE #3 DRIVER BIT  
WITH A BIT EXTENSION

### 4. Attach the feet assembly to the side posts, as shown.

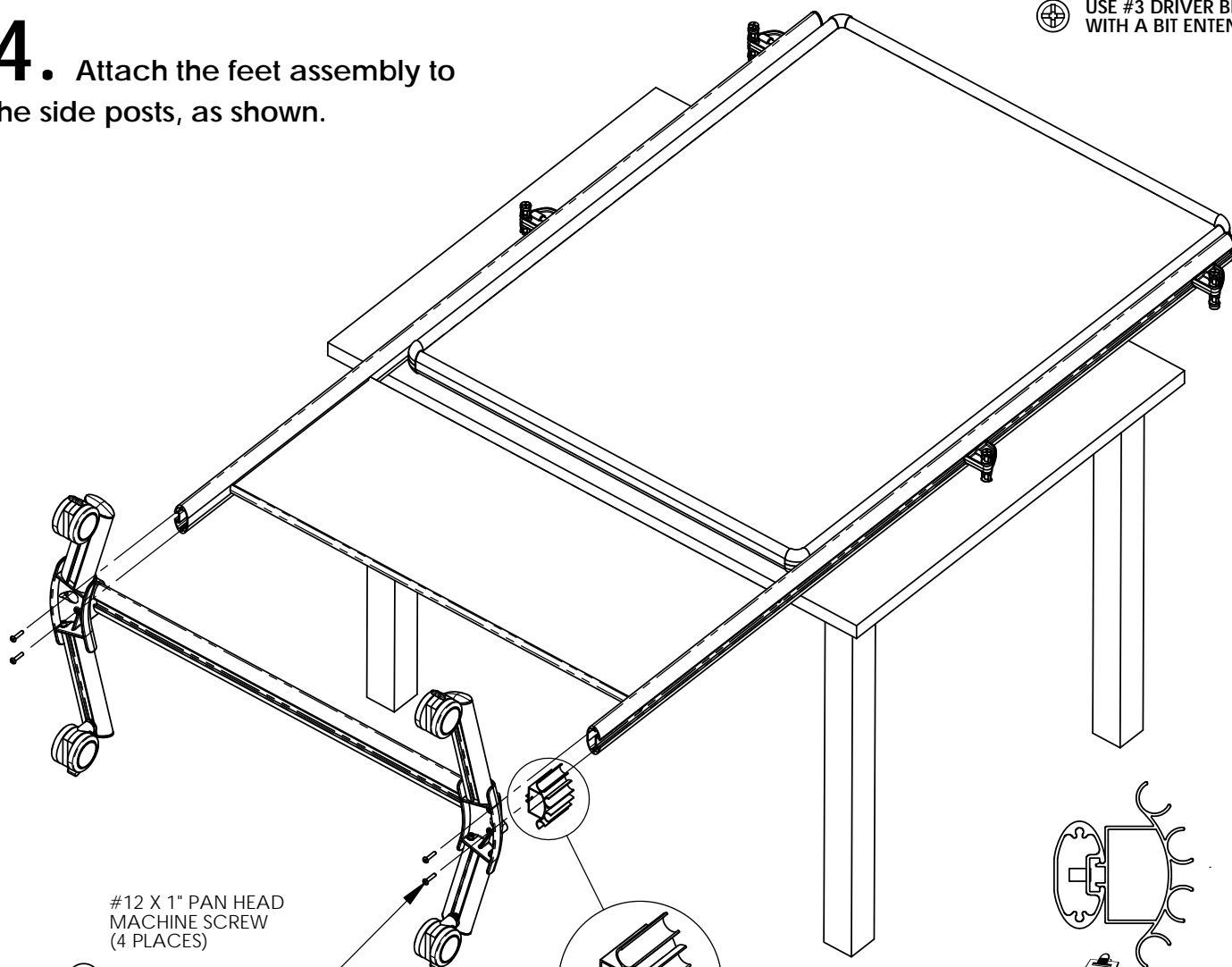

#12 X 1" PAN HEAD  
MACHINE SCREW  
(4 PLACES)

USE #3 DRIVER BIT

HOLE  
ORIENTATION

SLIDE THE MARKER/ERASER  
HOLDER INTO THE SIDE POST  
ACCESSORY CHANNEL BEFORE  
ATTACHING THE FEET ASSEMBLY.

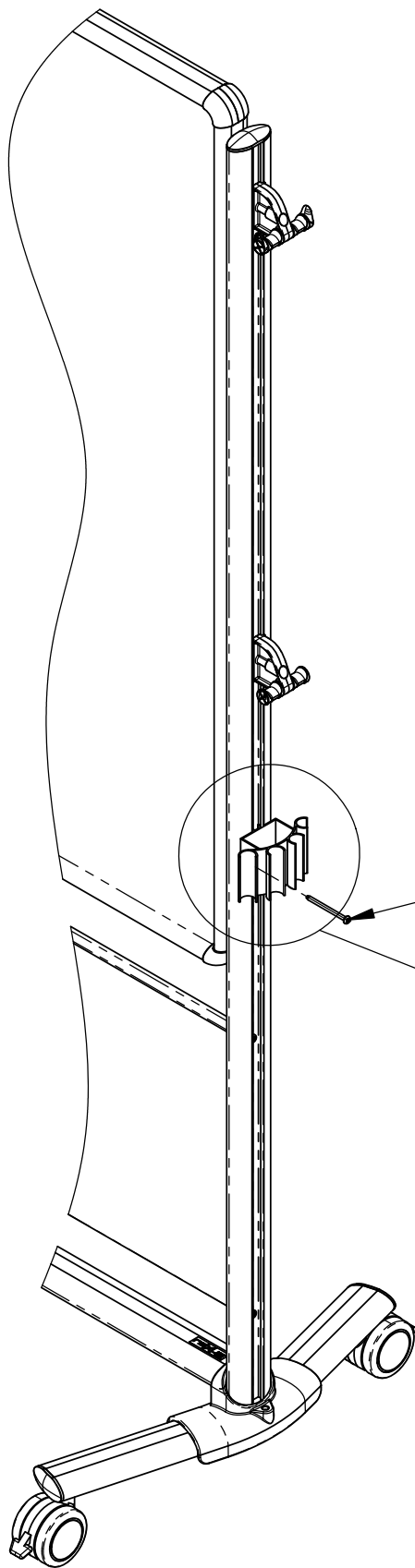

**5.** Slide the marker/eraser holder up into position above the accent panel and attach with the screw as shown.

#10 X 2 1/2" PAN HEAD  
MACHINE SCREW

⊕ USE #2 DRIVER BIT

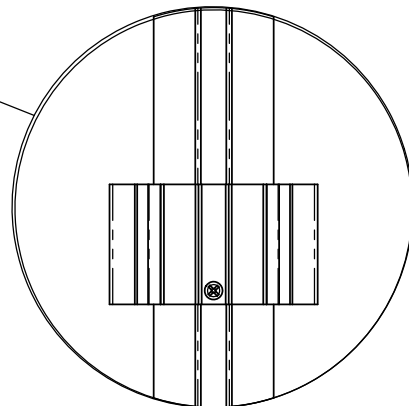

**6.** Tighten all screws to complete the assembly.