

VALUE DRUM CARRIER AND DISPENSER

- Three height adjustments: 9.25", 10.625" and 12".
- Vertical and horizontal locking positions.

P/N 272404

Model: VDCD
 Full Drum Capacity: 800 lbs
 Half Drum Capacity: 500 lbs
 Weight: 105 lbs
 Wheel: 8" x 2" Poly.
 Caster: 4" x 1.25" Poly.

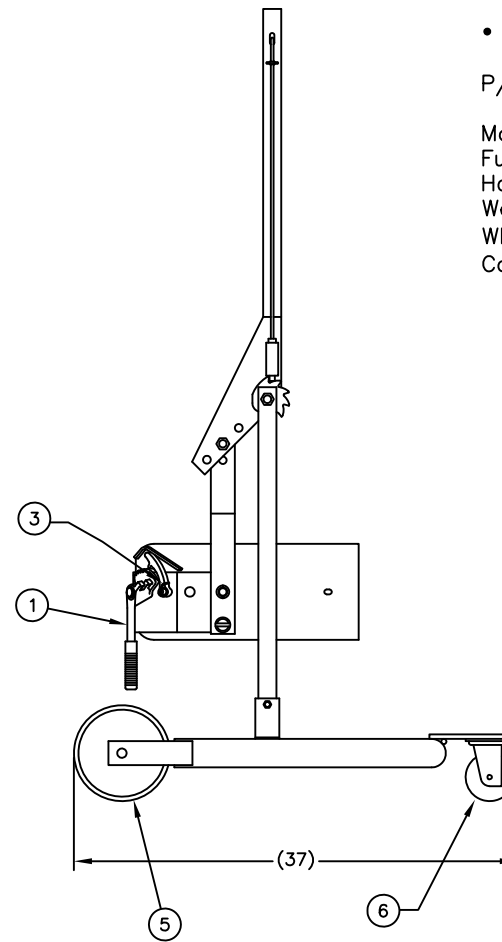
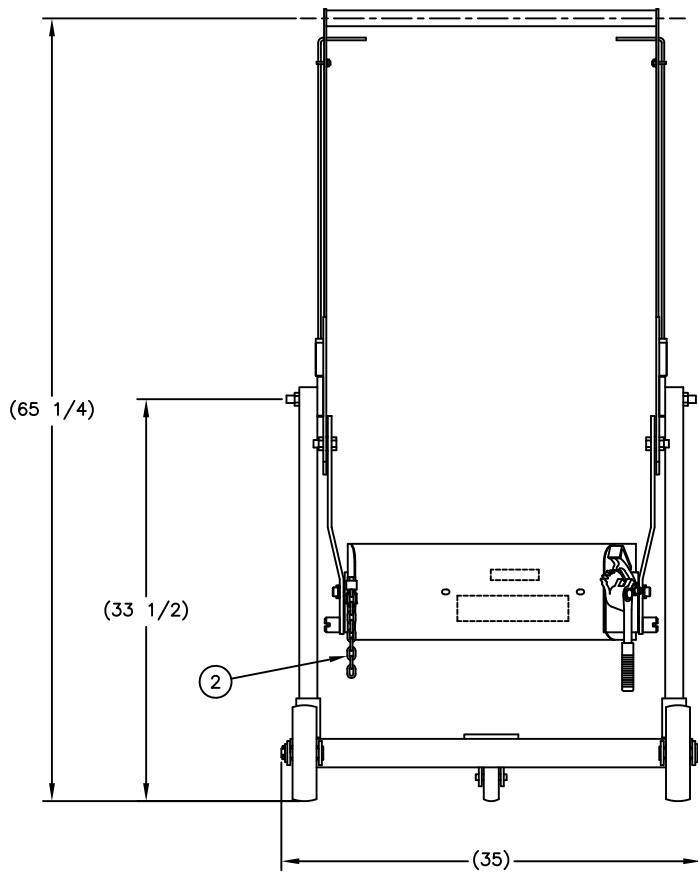

THIS DRAWING IN ALL PARTICULARS IS WESCO INDUSTRIAL PRODUCTS INC. PROPERTY. ALL RIGHTS OF DESIGN, INVENTION OR USE OF ARE RESERVED.

PRINT ISSUED

OCT 13, 2005

WESCO MANUFACTURING
 ENGINEERING DEPARTMENT

| | | |
|-----------|---------------------|---------|
| REV. | EDN & DATE | APPROV. |
| A | 12-04-12 UPDATED | R W S |
| REVISIONS | | |

| | |
|--|-------|
| WESCO INDUSTRIAL PRODUCTS INC. NORTH WALES PENNA. 19454 | |
| PART NAME | VDCD |
| DRAWN: RDS 10-13-05 | |
| CHECKED: | |
| APP. ENGR. | |
| SCALE: 1:8 | |
| TOLERANCE UNLESS OTHERWISE SPECIFIED FRACTION 3 PLACE DECIMAL 2 PLACE DECIMAL ± 1/64 ± .005 ± .01 ANGULAR ± 1-1/2° SHEET 1 OF 2 BREAK ALL SHARP EDGES AND REMOVE ALL BURRS | |
| C-240037 | REV A |

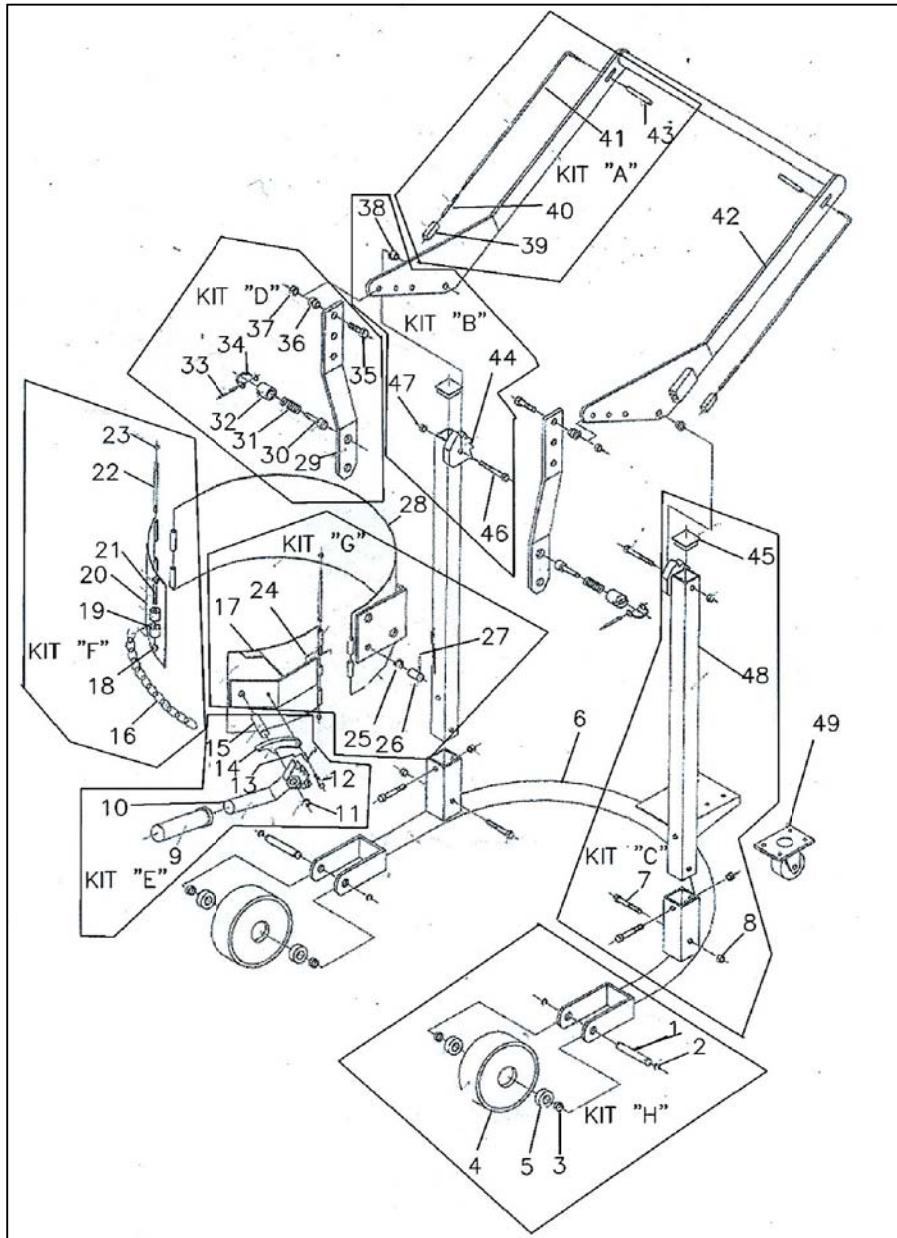

| NON KIT ITEMS | | | | KIT ASSEMBLIES | | | | |
|---------------|----------|-----------------|-----|----------------|----------|----------------|-----------------------------|------|
| ITEM | PART NO. | DESCRIPTION | QTY | KIT | PART NO. | KIT COMPONENTS | | |
| | | | | | | ITEM | DESCRIPTION | QTY. |
| 6 | 170753 | CHASSIS | 1 | A | 170745 | | | |
| 28 | 170754 | SUPPORTING HOOP | 1 | | | 39 | SLIDING BLOCK | 1 |
| 42 | 170755 | LIFTING ARM | 1 | | | 40 | SPRING | 1 |
| 49 | 170756 | BACK WHEEL | 1 | | | 41 | LEVER | 1 |
| | | | | | | 43 | TAPPER PIPE | 1 |
| | | | | B | 170746 | | | |
| | | | | | | 38 | SEPARATE RING | 1 |
| | | | | | | 44 | DENTATION CLAW 1 LH, 1 RH | |
| | | | | | | 46 | BOLT | 1 |
| | | | | | | 47 | LOCK NUT | 1 |
| | | | | C | 170747 | | | |
| | | | | | | 7 | BOLT | 2 |
| | | | | | | 8 | LOCK NUT | 2 |
| | | | | | | 45 | SQUARE PLUG | 1 |
| | | | | | | 48 | MAST | 1 |
| | | | | D | 170748 | | | |
| | | | | | | 29 | HANGER PLATE | 1 |
| | | | | | | 30 | SLIDING PIN | 1 |
| | | | | | | 31 | SPRING | 1 |
| | | | | | | 32 | SLIDING BUSH | 1 |
| | | | | | | 33 | RETAINING RING | 1 |
| | | | | | | 34 | EXTENSION RING | 1 |
| | | | | | | 35 | BOLT | 1 |
| | | | | | | 36 | SEPARATE RING | 1 |
| | | | | | | 37 | BOLT | 1 |
| | | | | E | 170749 | | | |
| | | | | | | 9 | RUBBER BUSH | |
| | | | | | | 10 | PAWL | 1 |
| | | | | | | 11 | RETAINING RING | 1 |
| | | | | | | 12 | BOLT | 1 |
| | | | | | | 13 | SPRING | 1 |
| | | | | | | 14 | DENTATION CLIP | 1 |
| | | | | | | 15 | PIN | 1 |
| | | | | F | 170750 | | | |
| | | | | | | 16 | CHAIN | 1 |
| | | | | | | 18 | NUT | 1 |
| | | | | | | 19 | HUB FOR CHAIN | 1 |
| | | | | | | 20 | DOOR | 1 |
| | | | | | | 21 | BOLT | 1 |
| | | | | | | 22 | PIN | 1 |
| | | | | | | 23 | LOCK NUT | 1 |
| | | | | G | 170751 | | | |
| | | | | | | 17 | MOBILE HUB | 1 |
| | | | | | | 24 | SPRING | 1 |
| | | | | | | 25 | WASHER | 1 |
| | | | | | | 26 | PIN | 1 |
| | | | | | | 27 | RETAINING RING | 1 |
| | | | | | | 28 | SUPPORTING HOOP | 1 |
| | | | | H | 170752 | | | |
| | | | | | | 1 | PIN | 1 |
| | | | | | | 2 | RETAINING RING | 2 |
| | | | | | | 3 | SEPARATE RING | 2 |
| | | | | | | 4 | FRONT WHEEL | 1 |
| | | | | | | 5 | BEARING | 2 |

THIS DRAWING IN ALL PARTICULARS IS WESCO INDUSTRIAL PRODUCTS INC. PROPERTY. ALL RIGHTS OF DESIGN, INVENTION OR USE OF ARE RESERVED.

PRINT ISSUED
 OCT 13, 2005
 WESCO MANUFACTURING
 ENGINEERING DEPARTMENT

12-04-12
 R W S
 A UPDATED
 REV. ECH & DATE APP

WESCO INDUSTRIAL PRODUCTS INC.
 NORTH WALES PENNA. 19454

PART NAME: VDCD
 DRAWN: RDS 10-13-05

CHECKED:
 APP. ENGR.

TOLERANCE UNLESS OTHERWISE SPECIFIED
 FRACTION 3 PLACE DECIMAL 2 PLACE DECIMAL
 ± 1/64 ± .008 ± .01

ANGULAR ± 1-1/2° SHEET 1 OF 1
 BREAK ALL SHARP EDGES AND REMOVE ALL BURRS

SCALE: 1:8
C-272404 REV A