



HSM[®]

Great Products, Great People.

OPERATING INSTRUCTIONS



HSM[®] ProfiPack P425

1 Intended use, warranty

The ProfiPack P425 is exclusively designed for the manufacture of packaging padding made from cardboard. The machine comes with a 2 year warranty. The warranty period is 6 months when used in multiple shifts. The warranty does not cover wear, damage caused by improper handling, natural wear or the intervention of third parties.

2 Explanation of symbols and safety instructions



Before starting up the machine for the first time, read the operating manual, and keep it for later use and to pass on to any subsequent users.

Please observe all of the safety instructions attached to the Profipack.



Risk of injury from the cutting unit

Cutting injuries are possible because of the sharp cutting unit.

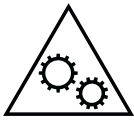

Risk of injuries from sharp blades!

Never reach into the slot of the paper feed.



Risk of injury from being pulled in!

Do not go near the infeed opening with long hair, loose clothing, ties, scarves, necklaces, bracelets etc. Do not shred any material that tends to form loops, e.g. tapes, bindings and soft plastic film.



Danger to children and other persons!

This equipment is not suitable for use in locations where children are likely to be present.



Danger from electric current

Dangerous mains voltage can lead to electrocution in the event of improper handling of the machine.



- Check the machine and cable regularly for damage.
- Switch off the Profipack and disconnect from the power supply in the event of damage, improper operation and also before changing location or cleaning.
- Make sure that the power plug is easily accessible.

- Before you insert the power plug, make sure that the voltage and frequency of your power supply comply with the information on the name plate.
- Prevent liquids getting into the Profipack.
- The machine must not be placed in the vicinity of a radiator or other heat source.
- The ventilation slots must not be blocked or covered and there must be at least 5 cm space between the shredder and any wall or furniture.
- Never pull the plug out of the socket using the power cable. Always pull out the plug directly.

Service work may only be carried out by HSM customer service and the service engineers from our contract partner. For our customer service addresses see page 168.

3 Transportation and installation



Connect the power cable to the machine. The machine must be connected to a power source which meets the specifications on the nameplate. Make sure that the power cable is unobstructed and that nobody can tread on it. Connect the power plug of the machine into a properly installed socket.



- Lock the front castors by pressing down the brake lever.

Note:

The HSM ProfiPack 425 can also be supplied with a built-in suction device. Using a suction device you can extract dust while processing the cardboard. If your device has the built-in suction device, there is a connection for the suction device on the right side (9). If your device does not have this apparatus, you can fit the components later when needed.

ProfiPack conversion kit:
Order number x.xxx.xxx.xxx
Dust extractor:
Order number 2.412.111

4 Overview



- 1 Feed opening
- 2 Safety notice
- 3 Warning sticker / type plate
- 4 Operator control panel
- 5 Emergency stop button
- 6 Limit stop
- 7 Rolls
- 8 "Slide" flap
- 9 Connection for suction device
- 10 Cable holder

5 Display and control panel

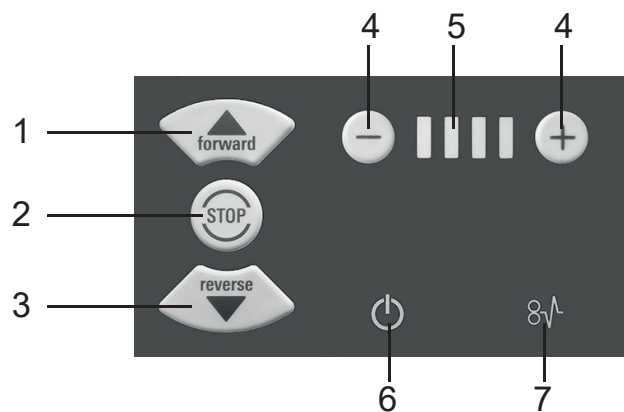

- 1 Forward button
- 2 Stop button
- 3 Reverse button
- 4 Settings buttons
- 5 "Speed" display
- 6 "Ready for operation" display
- 7 "Blockage" display

6 Operation

Switching the system on



- Unlock the emergency stop button by turning it anti-clockwise.



- Move the power switch at the right-hand side to position "I".

➤ "Ready for operation" display flashes. The "Ready for operation" display illuminates constantly after a short period of time. The machine is ready to operate.

Press the "Forward button".
The cutting unit starts up.

The operating speed can be controlled in 4 levels using the - and + adjustment buttons. Changing the settings during operation is possible.

Adjustable limit stop

Lever up: For moving
Lever down: Limit stop fixed

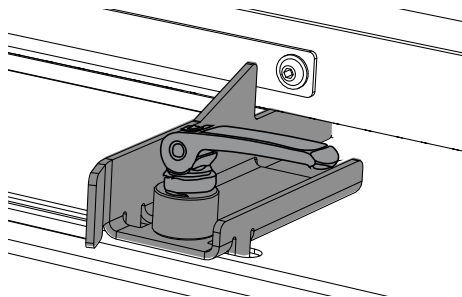

Feed in cardboard



- Cardboard is processed at a width of up to 425 mm.
- Wider cardboard is automatically trimmed.
- The cutting unit is switched off using the stop button.

Switch off

Switch the mains switch on the right side to position "0".

CAUTION**Removing material residue**

- ▶ Observe the following for all work on the compression flap:
Wear gloves.

**Perforating cardboard**

- Lever (1) is in lower position
- Catch bolt is engaged
- Feed in the cardboard

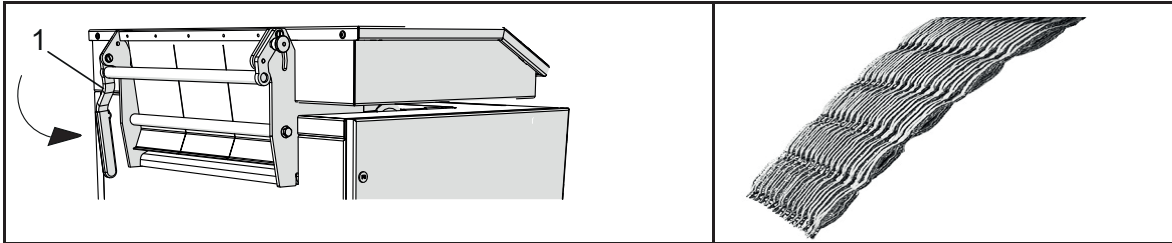
**Padding cardboard**

- Pull catch bolt (1)
- Pull lever (2) upwards.
- Feed in approx. 2 linear metres of cardboard

1

- Push the lever (2) downwards.
- Feed in the cardboard

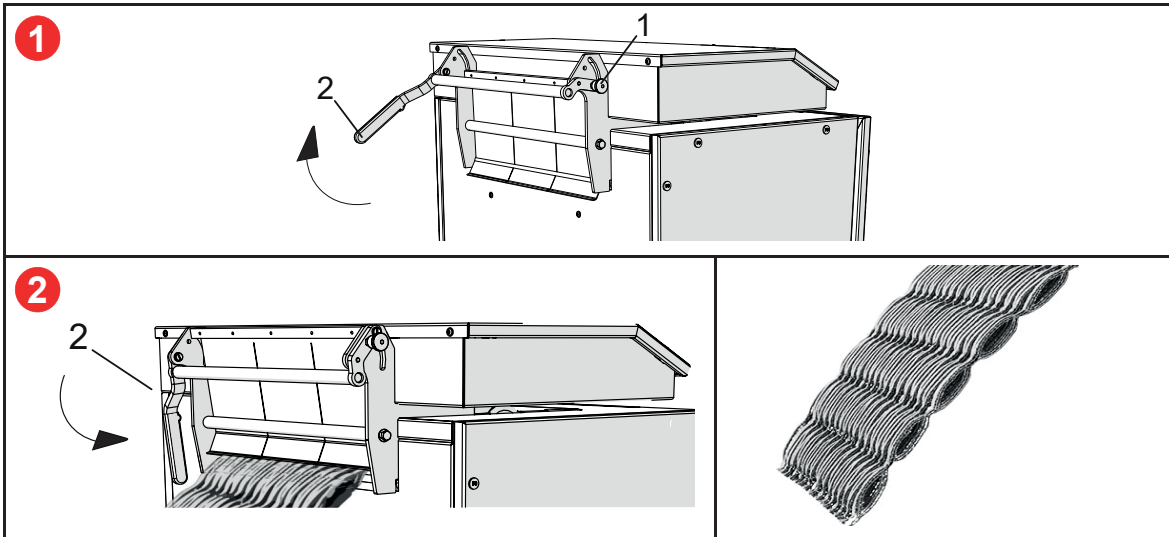
2

Remove material residue when changing from “Padding cardboard” to “Perforating cardboard”.

- Switch off the machine. Turn the power switch to the “0” position.
- Remove residual material on the pressing plate by hand.
- Switch on the machine. Turn the power switch to the “1” position.
- Push in compact cardboard to order to clear the shaft of any residual material.
- Remove any remaining residual material by hand.

7 Troubleshooting

Blockage

Press the “Reverse button” to remove material in the event of problems.

- The cutting unit reverses slowly and slides the cardboard back.

Note

If a large quantity of cardboard has already been pulled in before the blockage occurred, you can also press the forward button. This makes the cutting unit run forwards slowly and shreds the remaining cardboard. During this function, the “Ready for operation” and “Blockage” indicators flash alternately.

For all other malfunctions, check whether the motor was overloaded before contacting our customer service. Let the machine cool down for approx. 15 – 20 mins. before restarting.

8 Cleaning

Switch off the machine and disconnect the power plug. When cleaning, only use a soft cloth and a mild soap-water solution. However, no water must enter the equipment.

9 Disposal/Recycling

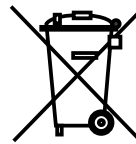

Dispose of the machine in an environmentally sound way at the end of its service life. Observe the current regulations when doing this. As legislation is subject to ongoing changes, we request that you contact your local authorities at the appropriate time. As the manufacturer, HSM would be glad to advise you on the disposal of your old machine.

10 Technical data

Grid dimension	5 x 100 mm
Cutting capacity	Up to 3 positions
Operating speed	8.5 – 14.0 m/min
Working width	425 mm
Infeed height	20 mm
Power supply	100V-240V / 50-60Hz , 220V-240V / 50-60Hz
Operating mode	Continuous operation
Power consumption max.	1.87 kW
Ambient conditions for transport, storage and operation: Temperature relative humidity height above SL	-10 °C up to +25 °C max. 90%, non-condensing max. 2,000 m
Noise emission (idle / under load)	60 – 62 dB(A) 66 – 67 dB(A)
Size W x D x H (mm)	770 x 570 x 1040
Weight	170 kg



This document shredder meets the applicable harmonisation legislation of the European Union:

- Low Voltage directive 2014/35/EU
- EMC directive 2014/30/EU
- RoHS directive 2011/65/EU

The EU declaration of conformity can be requested from the manufacturer.



- Electrical Equipment (Safety) Regulations 2016
- Electromagnetic Compatibility Regulations 2016
- The Restriction of the Use of Certain Hazardous Substances in Electrical and Electronic Equipment Regulations 2012

The EU declaration of conformity can be requested from the manufacturer.

HSM GmbH + Co. KG

Austraße 1-9
88699 Frickingen / Germany

Tel. +49 7554 2100-0
Fax +49 7554 2100 160
info@hsm.eu
www.hsm.eu

Gratis Hotline

DE, AT, IT, ES, BE, NL, LU
Tel. 00800 44 77 77 66

E-Mail

HSM Vertrieb Deutschland
deutschland@hsm.eu

HSM Vertrieb Österreich
austria@hsm.eu

HSM Vertrieb Schweiz
schweiz@hsm.eu

HSM Verkoop België, Nederland, Luxemburg
benelux@hsm.eu

HSM Commerciale Italia
italia@hsm.eu

HSM Ventas Portugal
iberia@hsm.eu

HSM of America LLC

419 Boot Road
Downingtown, PA 19335
USA

Tel. +1 800 613-2110
Fax +1 484 698-7978
customerservice@hsm.us
info@hsm.us
www.hsm.us

HSM France SAS

Parc de Genève
240, Rue Ferdinand Perrier
69800 Saint-Priest
France
Tél. +33 472 210580
Fax +33 472 517481
france@hsm.eu
www.hsm.eu

HSM Técnica de Oficina y Medioambiente España, S.L.U.

Calle de José Echegaray, 10
28100 Alcobendas, Madrid
Spain
Tel. +34 91 103 4859
Fax +34 91 103 4858
iberia@hsm.eu
www.hsm.eu

HSM®

Great Products, Great People.