



UNASSEMBLED BOX LOCKERS THREE WIDE UNIT

Tennsco Corp., Dickson, TN 37056-1888 • (615) 446-8000

RETAIN INSTRUCTIONS FOR FUTURE REFERENCE!

Tennsco box lockers are designed for use in schools, hospitals, businesses, and institutions where space is limited. They are highly suitable for securing small personal items such as books, shoes, purses, etc. Five or six tier, single and three wide units are available in 12" and 15" widths and 12", 15" and 18" depths with or without legs.

Basic Construction:

All models are constructed of 16 gauge steel frames and doors and 24 gauge body components. Doors are louvered for ventilation. Heavy gauge steel construction with baked-on powder coat finish assures you years of trouble-free service, even under the most demanding situations. Each door has a finger tab pull with a built-in padlock hasp. Optional built-in key locks or combination locks may be installed. Other options available are front bases, end bases and sloping tops.

GENERAL SAFETY INFORMATION

Some parts may have sharp edges. CARE must be taken when handling various pieces to avoid injury. For safety, wear a pair of work gloves when assembling or performing any maintenance on lockers.



LIMITED WARRANTY

Tennsco warrants goods purchased hereunder to be free of defects in materials and workmanship for a period of one (1) year from the date of shipment, hereunder. This warranty shall not apply in the event goods are damaged as a result of misuse, abuse, neglect, accident, improper application, modification or repair by persons not authorized by Seller, where goods are damaged during shipment, or where the date stamps on the goods have been defaced, modified or removed. UNLESS CONSIDERED UNENFORCEABLE OR UNLAWFUL UNDER APPLICABLE LAW:

- a. ALL IMPLIED WARRANTIES, INCLUDING BUT NOT LIMITED TO WARRANTIES OR MERCHANTABILITY AND FITNESS FOR A PARTICULAR PURPOSE ARE HEREBY EXCLUDED:
- b. BUYERS REMEDY, IF ANY, FOR ANY DEFECTIVE GOODS SHALL BE LIMITED TO A REFUND BY SELLER OR REPLACEMENT OF THE GOODS AT SELLER'S OPTION, AND SHALL IN NO EVENT INCLUDE DAMAGES OF ANY KIND, WHETHER INCIDENTAL, CONSEQUENTIAL OR OTHERWISE.

NO GOODS ACCEPTED FOR RETURN WITHOUT PRIOR APPROVAL. Seller shall have the right to inspect any goods claimed to be defective at Buyers place of business or require Buyer to return the goods to Seller for inspection on Seller's premises. Transportation charges covering returned goods will be borne by Seller only if such goods are proven to be defective, are covered by this warranty and are returned within the warranty period stated above.

TENNSCO Corp., P.O. BOX 1888, DICKSON, TN 37056-1888
(615) 446-8000 or (866) 446-8686 (toll free)
Website: www.tennsco.com E-mail: Info@tennsco.com

ASSEMBLY OF BOX LOCKERS -- THREE WIDE UNIT

Tools required: 11/32" nut driver (11/32" socket may be substituted).
Estimated assembly time for two people is 30 min.

1. All reference numbers refer to the illustrations in Figure 1, the door detail, and the chart on the back cover. This is to help you identify the various parts as they are mentioned. Unpack all parts, locate and identify the left and right sides and separate them. The top of the sides and back panel can be determined by the three holes closest to the end as shown.

2. Place back (Ref. No. 1) on a protected flat surface so that the flanges face upward. If available, place the unit on a pair of "saw horses" for easier assembly. Keep all parts level and square during assembly. Make sure all parts are aligned properly before tightening the bolts and nuts.

3. Bolt left side (Ref. No. 2) to the back so that side flange fits around back using 7 bolts and nuts (nuts to the inside); use 9 if the locker does not have legs.

If leg version do not bolt through bottom two holes yet.

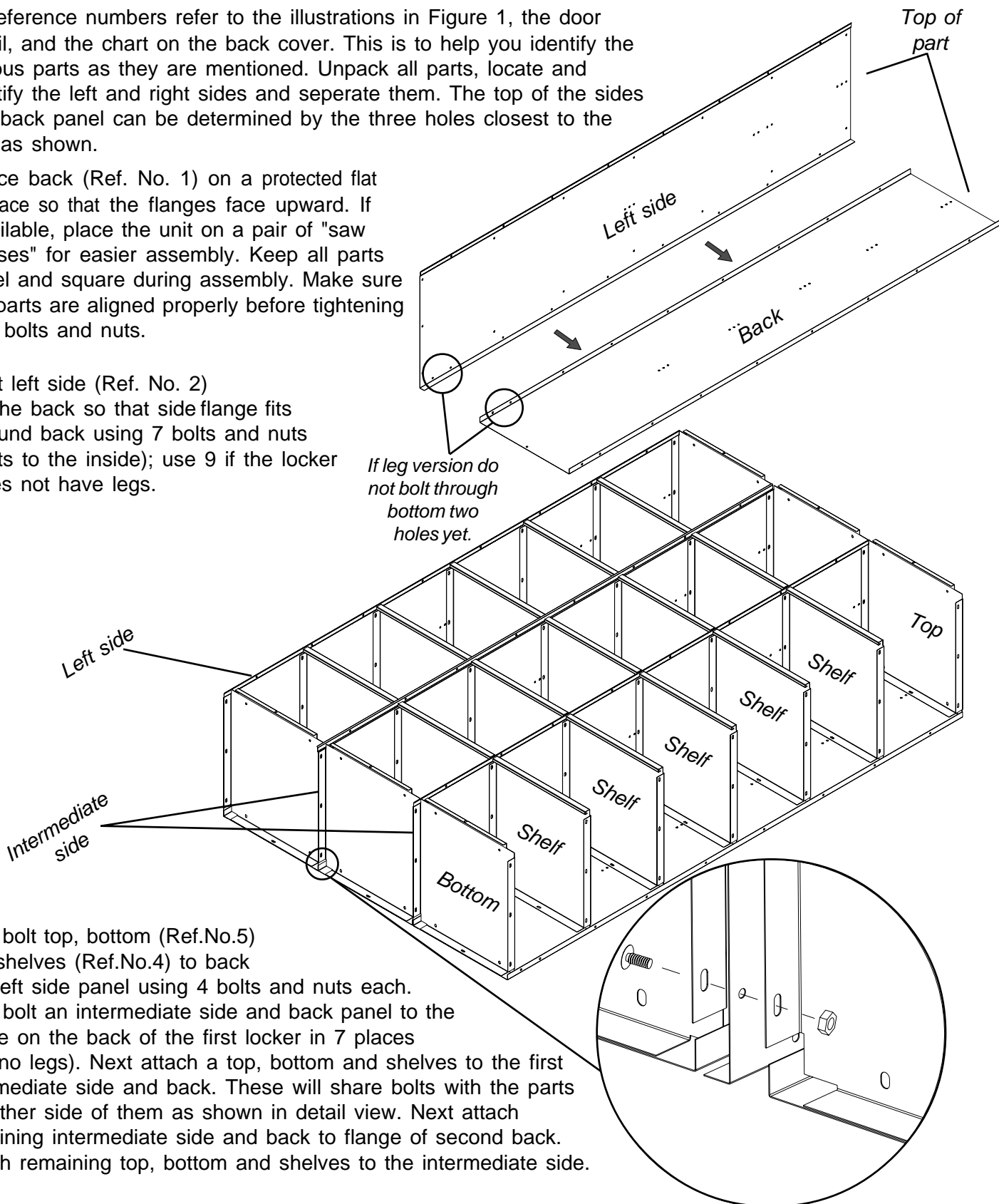

4. Next bolt top, bottom (Ref.No.5) and shelves (Ref.No.4) to back and left side panel using 4 bolts and nuts each. Next bolt an intermediate side and back panel to the flange on the back of the first locker in 7 places (9 if no legs). Next attach a top, bottom and shelves to the first intermediate side and back. These will share bolts with the parts on either side of them as shown in detail view. Next attach remaining intermediate side and back to flange of second back. Attach remaining top, bottom and shelves to the intermediate side.

5. Bolt right side (Ref. No. 6) to the back so that side flange fits around back, then attach side to top, bottom and shelves. Use 23 bolts and nuts (unit without legs) to complete this step.

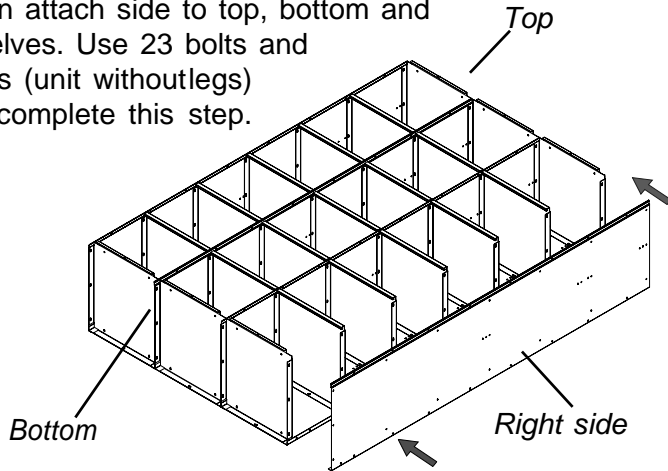

6. If the locker has legs, insert the leg into the corner between the bottom and the side as shown. Bolt the leg to the side using two bolts and nuts per leg.

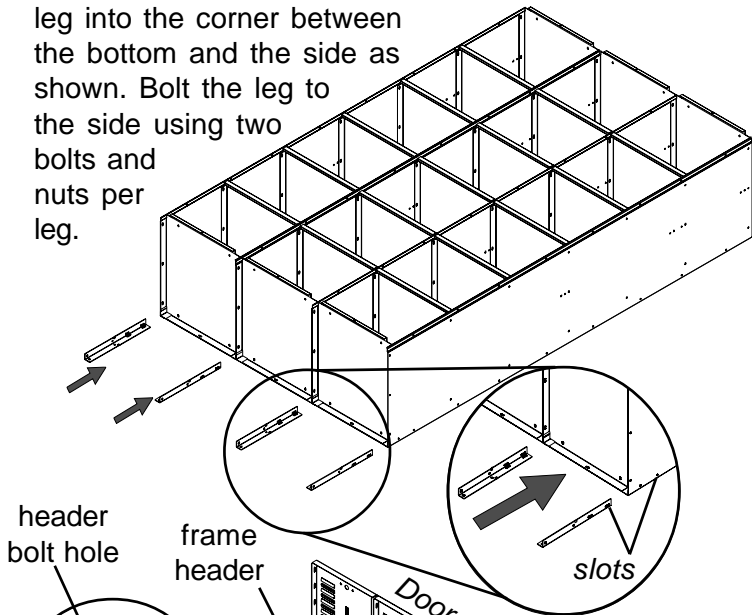

7. Place frame and door assemblies (Ref. Nos. 7 & 8) over the locker body. Make certain that body sides are inside frames not between the frames. Attach top to frame header and the bottom to frame sill (one bolt each).

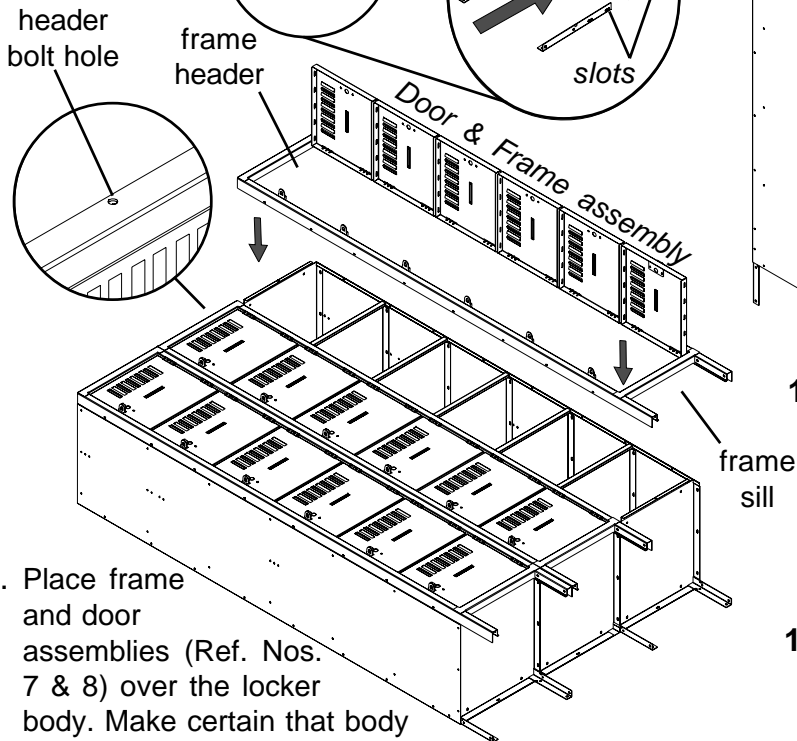

8. If joining a 3-wide unit beside another unit, temporarily install a bolt and nut into the third and sixth holes down from the top of the outer frame(s) that will be joined to the adjacent locker frame(s). The center locker frame can be bolted complete. If locker is just a stand alone three wide unit finish attaching the frames using 38 bolts and nuts. Check and tighten all permanent bolts.

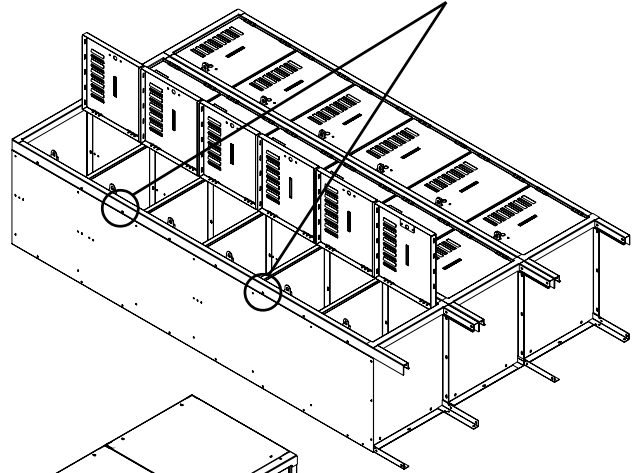

9. Stand unit upright and place in desired location. Remove temporary bolts in frames and bolt to adjacent units together through frames. **NOTE:** If the temporary bolts are not removed before the frames are joined side by side, the frames will have a 1/8" gap between them.

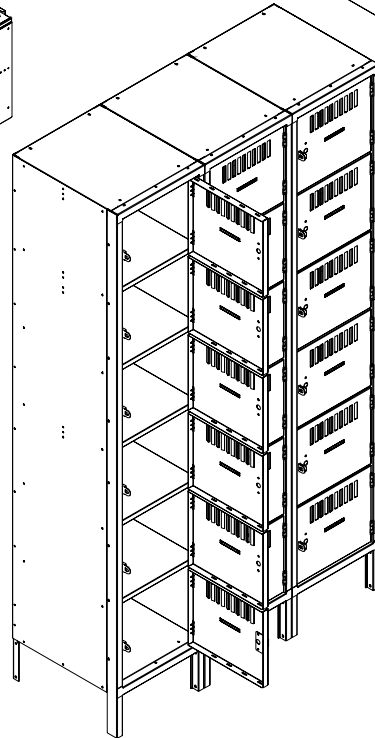

10. Anchor units to wall or floor. The units are not intended to stand free and may topple if not secured. (Units standing back to back should be bolted back to back.)

Care must be taken to assure that lockers are set plumb and level before anchoring.

11. If units are not pre-numbered, optional number plates and plastic cover (Ref. No. 9) may be attached using push plugs (Ref. No. 10). Custom number can be ordered from factory.

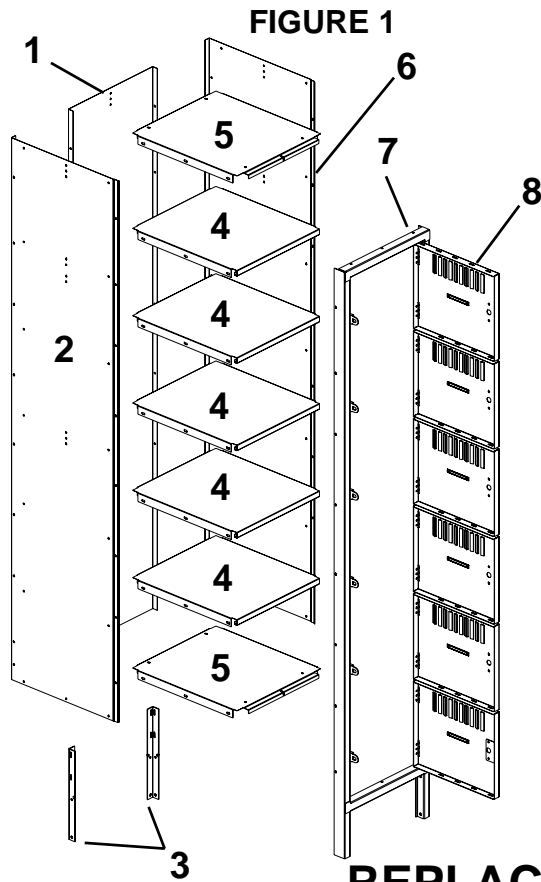

DOOR DETAIL

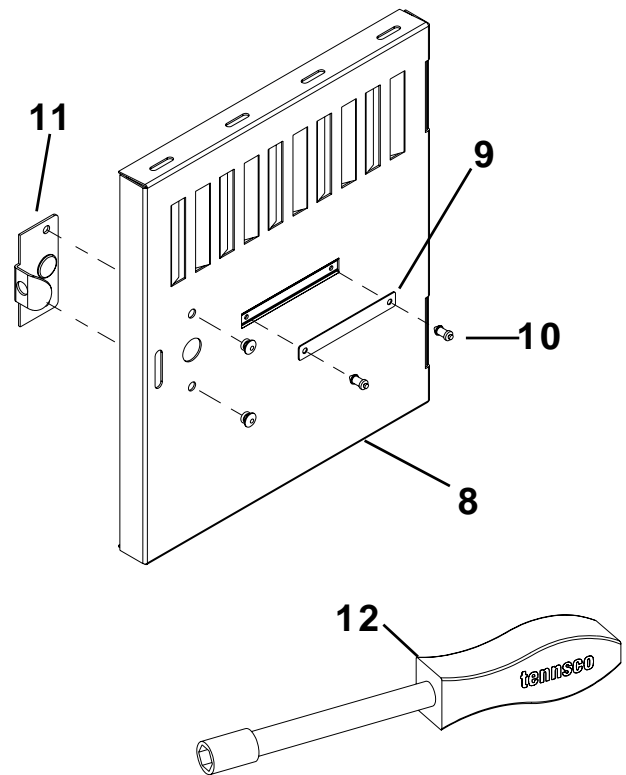

REPLACEMENT PARTS

REF. NO.	DESCRIPTION	PART NO.	QUANTITY FOR ONE 3-WIDE 5 TIER	QUANTITY FOR ONE 3-WIDE 6 TIER
1	Back	LSTB-wwhh *	3	3
2	Left side	LBSL-ddhh *	2	2
3	Rear leg -- leg version unit only	LRL-1	4	4
4	Shelf	ESL-wwdd *	12	15
5	Top/Bottom	LTB-wwdd *	6	6
6	Right side	LBSR-ddhh *	2	2
7	Door frame assembly	LBFA-wwhh-x **	3	3
8	Locker Door	LB-wwhh *	15	18
9	Number plate and clear label cover	LNP-1 ◆	15	18
10	Push plug	LPP-1 ◆	30	36
11	Finger Pull	LFP-1	15	18
12	Tensco 11/32" nut driver	TOOL-2 ◆	1	1
13	Bolts and Nuts #8-32 X 1/2"	----- ◆	136	144

- * Part No. is composed of prefix shown plus combination of opening width = ww, depth = dd and height = hh.
- ** Door frame assemblies require a further suffix (x) of either 1 or A. "1" indicates frame with legs; "A" indicates frame without legs. For example: A door frame assembly for locker BK6-121812-1 with legs would be Part No. LBFA-1272-1. The door assembly alone without the frame would be Part No. LBD-1212 for the same locker.
- ◆ These items are included in the Hardware pack model# HWBD53- 5 tier locker, # HWBD63- 6 tier locker.

We make every effort to ensure that all units ship complete and arrive undamaged. However, should your unit contain missing or damaged parts, replacements may be obtained directly from us. To obtain proper replacement parts, follow the instructions below, or fill out the form at www.tensco.com/partsorder.html.

TO OBTAIN PROPER REPLACEMENT PARTS, PLEASE PROVIDE THE FOLLOWING INFORMATION:

- Model Number
- Description of part(s) needed and part number(s) as shown in Parts List (above)
- Color (i.e. Medium Grey, Sand, etc.)
- Was item missing, or was it damaged?
- Purchase Date
- Your company name
- Contact person's name
- Company the product was purchased from

Tensco Corp., P.O. Box 1888, Dickson, TN 37056-1888 E-mail address: info@tensco.com

Customer Service: (866) 446-8686 Fax: (866) 445-7260

If requesting parts by telephone, ask for customer service and have as much of the above information ready as possible.