

ASSEMBLY INSTRUCTION

REMOVE ALL ITEMS FROM THE CARTON. VERIFY ALL PIECES BEFORE ASSEMBLY.

PARTS LIST

KEY	QTY	DESCRIPTION
1	5	CASTER
2	1	BASE
3	1	SEAT POST
4	1	PLASTIC BELLOW
5	1	KNOB FOR IN & OUT
6	1	FLAT WASHER
7	1	LOCK WASHER
8	1	MECHANISM CONTROL
9	1	BACKREST POST + PLASTIC COVER
10	1	BACKREST
11	1	SEAT
12	1	PLASTIC COVER
13	1	STEEL PLATE
14	1	PLASTIC HOLDER
15	2	BACKREST SCREW
16	1	KNOB FOR UP & DOWN + WASHER

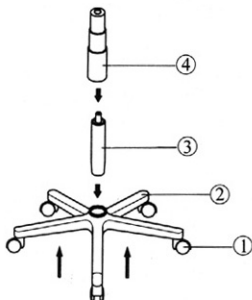

STEP 1.

- Insert (1) casters into (2) base. Insert (3) seat post in (2) base. Slide (4) plastic bellow over (3) seat post.

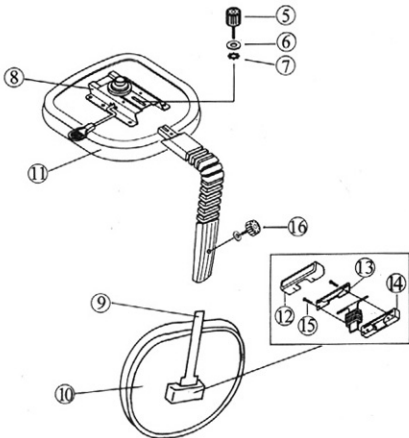

STEP 2.

- Insert (10) backrest into (9) backrest post + plastic holder. Securely tighten with (16) knob for up & down + washer. Afterwards, insert (9) backrest post into (8) mechanism control and securely tighten with (5) knob for in & out + (6) and (7) flat & lock washers. Adjust knobs to desired position.

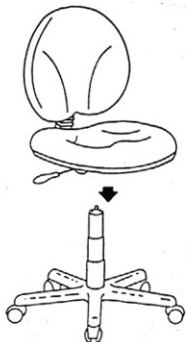

STEP 3.

- Place upper assembled portion of chair into (3) seat post.