

Remove all items from the carton. Verify all pieces before assembly

PART LIST

KEY	QTY	DESCRIPTION	KEY	QTY	DESCRIPTION	KEY	QTY	DESCRIPTION
1	5	Caster	5	1	Mechanism	9	6	Mechanism + Back attachment Screws (5/16"*1-1/4")
2	1	Base	6	1	Seat	10	2	Mechanism Screws (5/16"*1")
3	1	Seat Post	7	1	Backrest	11	4	Armrest Screws (1/4"*2-1/2")
4	1	Seat Post Cover	8	2	Armrest	12	1	Allen Wrench

STEP 1.

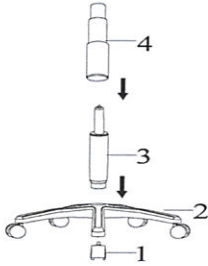

STEP 2.

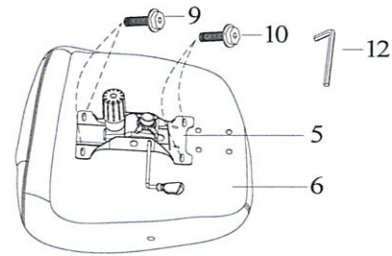

STEP 3.

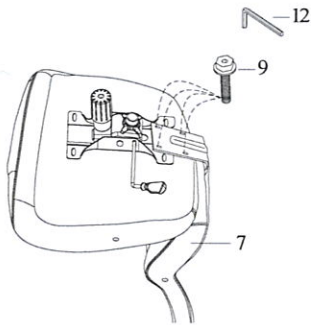

STEP 4.

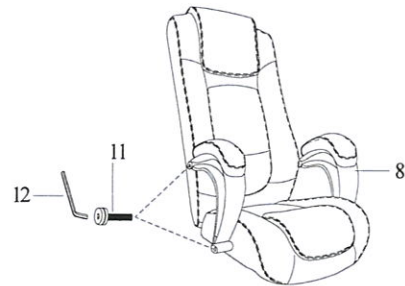

STEP 5.



NOTICE:
EVERY 6 MONTHS, PLEASE MAKE SURE ALL BOLTS, SCREWS AND KNOBS ARE FULLY TIGHTENED TO ENSURE STABILITY.

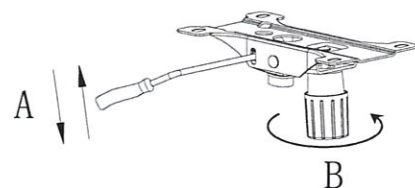

MECHANISM OPERATION INSTRUCTION WHILE SEATED:
(A) SEAT HEIGHT ADJUSTMENT:
Pull lever up. Release lever when desired position is reached.
(B) TILT TENSION ADJUSTMENT KNOB:
Rotate knob clockwise/counterclockwise to adjust tilt tension based on body weight.

PREVENTIVE MAINTENANCE AND WARNING!

- USE THIS PRODUCT ONLY FOR SEATING ONE PERSON AT A TIME.
- DO NOT USE THIS CHAIR AS A STEP STOOL/LADDER.
- DO NOT SIT ON ANY PART OF THE CHAIR EXCEPT THE SEAT.
- DO NOT USE CHAIR ON UNEVEN FLOOR SURFACES.
- DO NOT USE CHAIR UNLESS ALL BOLTS, SCREWS AND KNOBS ARE TIGHT.
- **AT LEAST EVERY SIX MONTHS, CHECK ALL BOLTS, SCREWS AND KNOBS TO BE SURE THEY ARE TIGHT.**
- IF ANY PARTS ARE MISSING, BROKEN, DAMAGED OR WORN, STOP USE OF THE PRODUCT UNTIL REPAIRS ARE MADE USING FACTORY AUTHORIZED PARTS.
- DISPOSE OF PACKAGING PROPERLY. PLASTIC BAG IS NOT A TOY. DO NOT USE PLASTIC BAG AS HEAD COVERING-IT MAY CAUSE SUFFOCATION.
- FAILURE TO FOLLOW THESE WARNINGS COULD RESULT IN SERIOUS INJURY.