

Special Notes

Before installing the DigiTech lock, insert the battery and familiarise yourself the the operation operation and programming.

Unless manufactured to special order, the lock you are receiving is in day-use operating mode. In this mode, the user must enter a four-digit code (twice) in order to lock the lock. The lock can be opened at any time using the Master Code.

Unless manufactured to special order, the default Master Code is **1 1 3 3 5 5 7 7**.

This code is common to all stadard locks and it is very important that you set your own personal Master Code. Your lock is not secure until you have changed the Master Code. Keep a safe record of your master code as it is not possible to make any programming changes without it.

See programming guide (over) to set you own codes.

ENSURE BATTERY IS CORRECTLY INSTALLED BEFORE ATTACHING LOCK

ELECTRONIC LOCK ASSEMBLY INSTRUCTION

- STEP 1
 UNPACK LOCK AND REMOVE CAM SCREW(5), WASHER(6) AND CLAMP COVER(3) FROM LOCK BODY(2). INSTALL BATTERY PER INSTRUCTION BELOW
- STEP 2
 INSERT LOCK BODY(2) THRU THE CUTOUT IN THE DOOR(1) WITH THE KEY END TOWARDS THE BOTTOM OF THE LOCKER/DOOR
- STEP 3
 INSERT CLAMP COVER(3) ON LOCK BODY(2) AND FASTEN WITH CLAMP NUT(8) AND CLAMP SCREW(4)
- STEP 4
 INSTALL CAM(7) ON LOCK WITH OFFSET TOWARDS LOCK BODY FASTEN WITH M4 SCREW(5) AND WASHER(6)
- NOTE: CAM(7) IS NOT INCLUDED WITH LOCK, IT SHIPS SEPARATELY
- STEP 5
 OPEN LOCK, CLOSE DOOR AND TEST LOCK.

INSERTING BATTERY

Remove all packaging
 Insert battery CR123 as shown
 Secure battery with battery cover using screw

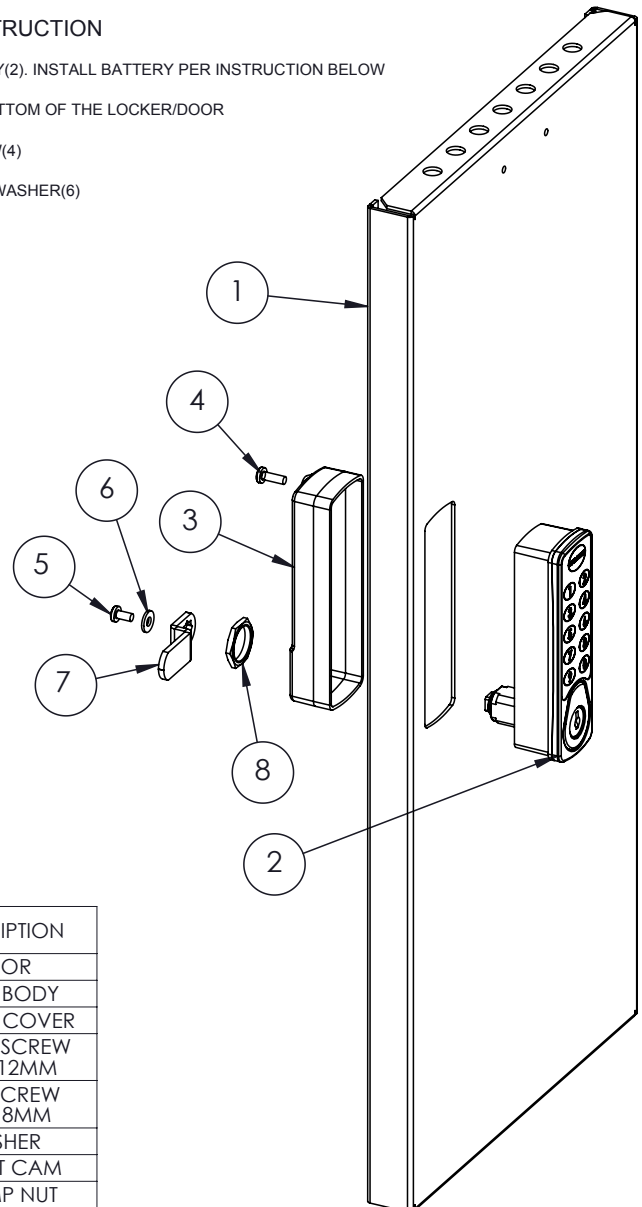
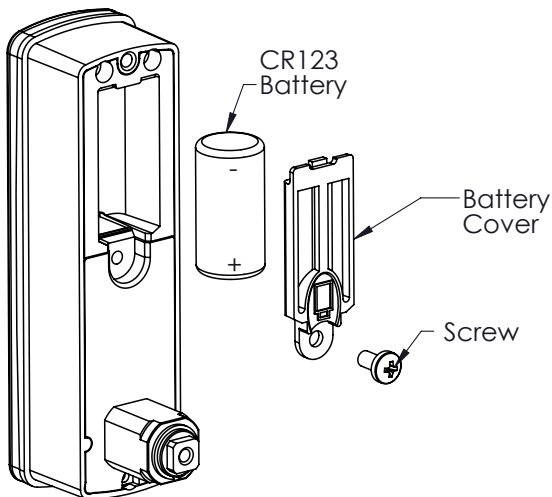

ITEM NUMBER	DESCRIPTION
1	DOOR
2	LOCK BODY
3	CLAMP COVER
4	CLAMP SCREW M4 X 12MM
5	CAM SCREW M4 X 8MM
6	WASHER
7	OFFSET CAM
8	CLAMP NUT

FUNCTION	MODE			KEY SEQUENCE	NOTES
	DAY USE	PERMANENT	MULTI USER		
MASTER CODE FUNCTIONS					
				STEP 1 STEP 2 STEP 3	
CHANGE MASTER CODE	✓	✓	✓	[logo] [Old Master Code] 01 [New Master Code] [New Master Code]	MASTER CODE IS EIGHT DIGITS
SET / CHANGE SUB-MASTER CODE	✓	✓	✓	[logo] [Master Code] 03 [New Sub-Master Code]	SUB-MASTER CODE IS SIX DIGITS
DELETE SUB-MASTER CODE	✓	✓	✓	[logo] [Master Code] 07	DELETES SUB-MASTER CODE
SET / CHANGE TECHNICIAN CODE	✓			[logo] [Master Code] 10 [New Technician Code]	TECHNICIAN CODE IS SIX DIGITS
DELETE TECHNICIAN MODE	✓			[logo] [Master Code] 11	DELETES TECHNICIAN CODE
CHANGE USER CODE		✓		[logo] [Master Code] 02 [New User Code]	USER CODE IS FOUR OR SIX DIGITS
SET SINGLE USER PRIVATE MODE FOUR DIGIT CODE	✓		✓	[logo] [Master Code] 09 [New Four Digit User Code]	SETS LOCK INTO FOUR DIGIT PRIVATE MODE - SINGLE USER ACCESS
SET MULTI-USER PRIVATE MODE (SIX DIGIT CODES)	✓	✓		[logo] [Master Code]	SETS LOCK INTO MULTI-USER MODE - NO USERS ARE ACTIVE INITIALLY
SET PUBLIC MODE - FOUR DIGIT CODE		✓	✓	[logo] [Master Code] 08	SETS LOCK INTO FOUR DIGIT PUBLIC MODE
SET AUDIBLE BUTTONS ON	✓	✓	✓	[logo] [Master Code] 12	LOCK WILL BEEP ON EACH BUTTON PRESS
SET AUDIBLE BUTTONS OFF	✓	✓	✓	[logo] [Master Code] 13	LOCK WILL OPERATE SILENTLY
SET UNSUCCESSFUL CODE LOCKOUT ON	✓	✓	✓	[logo] [Master Code] 24	KEYPAD IS DISABLED FOR A SHORT TIME FOLLOWING FIVE INCORRECT ENTRY ATTEMPTS
SET UNSUCCESSFUL CODE LOCKOUT OFF	✓	✓	✓	[logo] [Master Code] 25	KEYPAD DISABLE IS TURNED OFF
SET TIMER AUTO-UNLOCK ON & SET TIME	✓			[logo] [Master Code] 16 [3 Digit Time Code]	AUTOMATICALLY OPENS LOCK AFTER SET TIME PERIOD. SEE NOTES ON TIMERS BELOW.
SET TIMER AUTO-UNLOCK OFF	✓			[logo] [Master Code] 17	UNIT WILL NO LONGER OPEN AUTOMATICALLY
SET AUTO-TIMED CODE CANCEL ON & SET TIME	✓			[logo] [Master Code] 26 [3 Digit Time Code]	DISABLES USER CODE AFTER SET TIME PERIOD. SEE NOTES ON TIMERS BELOW.
SET AUTO-TIMED CODE CANCEL OFF	✓			[logo] [Master Code] 27	UNIT WILL NO LONGER CANCEL USER CODE
OPEN LOCK AND DELETE USER CODE	✓			[Master Code]	MASTER CODE IS EIGHT DIGITS
OPEN LOCK		✓	✓	[Master Code]	MASTER CODE IS EIGHT DIGITS
CLOSE LOCK		✓	✓		PUSH HANDLE BACK INTO UNIT
SUB-MASTER CODE FUNCTIONS					
CHANGE SUB-MASTER CODE	✓	✓	✓	[logo] [Sub-Master Code] 03 [New Sub-Master Code] [New Sub-Master Code]	SUB-MASTER CODE IS SIX DIGITS
CHANGE USER CODE		✓		[logo] [Sub-Master Code] 02 [New User Code]	USER CODE IS FOUR DIGITS
OPEN LOCK AND DELETE USER CODE	✓			[Sub-Master Code]	SUB-MASTER CODE IS SIX DIGITS.
OPEN LOCK		✓	✓	[Sub-Master Code]	SUB-MASTER CODE IS SIX DIGITS.
CLOSE LOCK		✓	✓		PUSH HANDLE BACK INTO UNIT
TECHNICIAN CODE FUNCTIONS					
OPEN LOCK AND RETAIN USER CODE	✓			[Technician Code]	TECHNICIAN CODE IS SIX DIGITS
OPEN LOCK		✓	✓	[Technician Code]	TECHNICIAN CODE IS SIX DIGITS
CLOSE LOCK	✓	✓	✓		PUSH HANDLE BACK INTO UNIT
USER CODE FUNCTIONS					
CHANGE USER CODE		✓		[logo] [User Code] 02 [New User Code] [New User Code]	USER CODE IS FOUR DIGITS
OPEN LOCK	✓	✓		[User Code]	USER CODE IS FOUR DIGITS
OPEN LOCK			✓	[Access Code]	ACCESS CODE IS TWO DIGIT USER REFERENCE FOLLOWED BY FOUR DIGIT USER CODE
CLOSE LOCK	✓			[User Code] [User Code]	WHEN DOUBLE USER CODE ENTRY MODE IS SET
CLOSE LOCK		✓	✓		PUSH HANDLE BACK INTO UNIT
FUNCTION AVAILABLE TO ALL CODES					
BATTERY CHECK	✓		✓	[logo] [logo]	REPLACE BATTERIES IF RED LIGHT SHOWS

NOTES	TIMER FUNCTIONS	TIME CODE EXAMPLES	BATTERY CONDITION INDICATOR
ALL ACCEPTABLE BUTTON PRESSES ARE SIGNIFIED BY A GREEN LIGHT.	TIME CODE 001	1 MIN	FOUR GREEN LIGHTS - EXCELLENT
	TIME CODE 010	10 MINS	THREE GREEN LIGHTS - VERY GOOD
INCOMPLETE FUNCTIONS "TIME-OUT" AFTER 4 SECONDS.	TIME CODE 030	1/2 HR	TWO GREEN LIGHTS - GOOD
	TIME CODE 060	1 HR	ONE GREEN LIGHT - LOW
ERRORS AND "TIME-OUTS" ARE SIGNIFIED BY FLASHING RED LIGHT.	TIME CODE 480	8 HRS	RED LIGHT -
	TIME CODE 720	12 HRS	CHANGE BATTERIES AS SOON AS POSSIBLE
FOLLOWING AN ERROR OR "TIME-OUT", UNIT REVERTS TO PREVIOUS SETTINGS.	TIME CODE 999	16 HRS 39 MINS (MAXIMUM)	FLASHING RED LIGHT PRIOR TO LOCK OR UNLOCK INDICATES LOW BATTERY VOLTAGE CHANGE BATTERIES AS SOON AS POSSIBLE
TIME CODES ARE 3-DIGIT CODES CORRESPONDING TO THE NUMBER OF MINUTES.	ALL TIMES ARE APPROXIMATE +/- 10%		

MASTER CODE (8 digits)
SUB-MASTER CODE (6 digits) (No Default)
USER CODE (4 digits)

ENSURE THAT YOU CHANGE THE DEFAULT MASTER CODE TO YOUR OWN MASTER CODE AND KEEP A SAFE RECORD IT IS NOT POSSIBLE TO PROGRAM THE LOCK WITHOUT IT