



Lotus™ DX Sit-Stand Workstation



PLEASE READ INSTRUCTIONS BEFORE USE.
DO NOT DISCARD.

LIRE LES INSTRUCTIONS AVANT UTILISATION.
NE PAS JETER.

LEA LAS INSTRUCCIONES ANTES DEL USO.
NO TIRAR.

BITTE LESEN SIE DIE ANLEITUNGEN SORGFÄLTIG DURCH,
BEVOR SIE DAS GERÄT BENUTZEN.
BITTE GUT AUFBEWAHREN.

LEGGERE LE ISTRUZIONI PRIMA DELL'USO.
NON GETTARE.

LEES DE INSTRUCTIES VOOR GEBRUIK.
NIET WEGWERPEN.

LÄS DESSA INSTRUKTIONER FÖRE ANVÄNDNING.
KASSERA EJ.

PRZED UŻYCIEM PROSZĘ PRZECZYTAĆ NINIEJSZĄ INSTRUKCJĘ.
NIE WYRZUCAĆ.

ПЕРЕД ИСПОЛЬЗОВАНИЕМ ПРОСЬБА ОЗНАКОМИТЬСЯ С
ИНСТРУКЦИЯМИ.
НЕ ВЫБРАСЫВАТЬ.

LEIA AS INSTRUÇÕES ANTES DA UTILIZAÇÃO.
NÃO AS ELIMINE.

SAFETY INSTRUCTIONS/WARNING

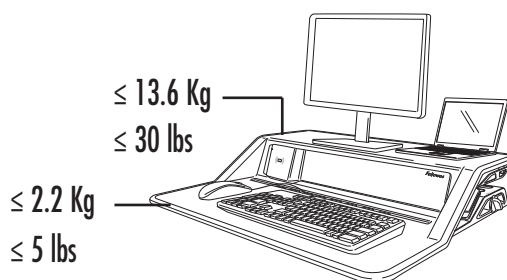

Read and follow all instructions and warnings before use.



- **WARNING: PINCH POINT! KEEP HANDS CLEAR OF SUPPORT BARS DURING OPERATION. SERIOUS INJURY MAY OCCUR.**
- **DO NOT EXCEED MAXIMUM STATED WEIGHT CAPACITY. SERIOUS INJURY OR PROPERTY DAMAGE MAY OCCUR.**
- **CAUTION: Lift hazard! Two people are required to move workstation. Serious injury may occur.**
- Keep cables clear of support bars during operation, follow the cable routing instruction in this manual. Failure to follow these instructions may result in equipment damage or personal injury.
- **DO NOT** lean on the keyboard platform.
- **DO NOT** adjust counter balance until all equipment and accessories have been placed on the workstation.
- This product is spring assisted and should never be used with less than 10 lbs. (4.5kg) of weight. With caution, use both hands to push down slightly and engage both levers. Failure to do so may result in injury or property damage.
- Only compatible with Fellowes Monitor Arm Kit for Lotus.
- Make sure the desk or mounting surface is level and can support the combined weight of the workstation and accessories.
- Remove all equipment and accessories from the workstation before moving.
- Manufacturer certifies that product meets or exceeds applicable ANSI/BIFMA standards.
- Use Velcro if not using monitor arms. Velcro is single use.
- The Lotus is for charging Qi™ compatible smartphone only.
- Only use the power cable and transformer that was supplied with this product.
- It is normal for the wireless charging surface to get warm during charging. If there is an issue while charging, the indicator lights will flash.
- Keep flammable materials away from charging surface.
- Only use the wireless charger for its intended purpose. Improper use, or use of incompatible devices may result in a risk of fire, explosion, or other hazard.
- **DO NOT** attempt to charge a device that is damaged or an open battery case or a device that is not Qi™ compatible.
- **DO NOT** disassemble the wireless charger and USB device.
- **DO NOT** use if power cord or transformer is damaged.
- Keep the wireless charging surface clean and dry.
- Use a soft, clean, dry cloth to clean the surface of the wireless charger.

CONTENTS

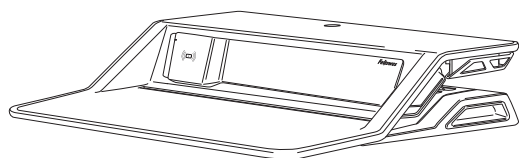

Workstation

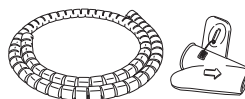

Cable zip/tool



Cord Funnel



Velcro

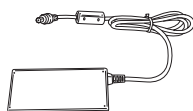

Power supply



Power cord



USB cord

Only compatible with Fellowes Monitor Arm Kit for Lotus. Visit www.Fellowes.com for more information.

CAPABILITIES

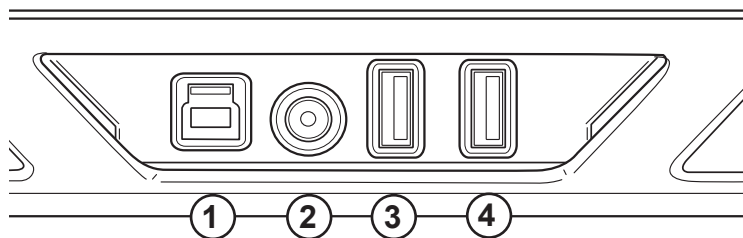

| | Port | Description | Specifications |
|--------------|------|--------------------------|-----------------------------|
| Rear USB Hub | 1 | Type B Connector | Data Transfer (to computer) |
| | 2 | Barrel Connector | Power (8A) |
| | 3 | USB Port (Data Transfer) | USB 3.0, 900mA |
| | 4 | USB Port (Data Transfer) | USB 3.0, 900mA |
| Front Panel | 5 | USB Port (Charging Only) | USB 3.0, 2.1A |
| | 6 | USB Port (Charging Only) | USB 3.0, 2.1A |
| | 7 | Wireless Charging Pad | 1A |

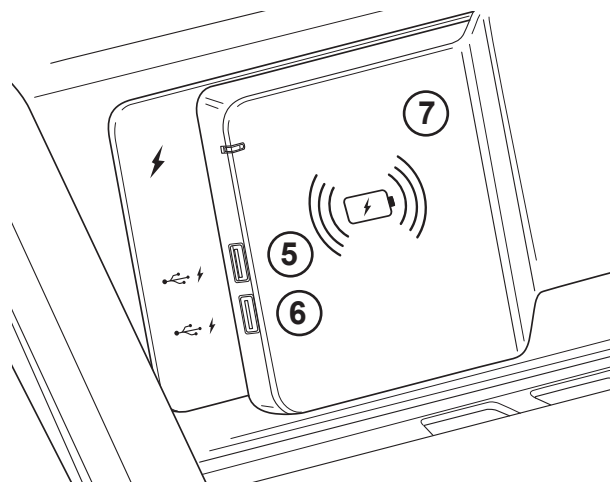

SET-UP

STEP 1

Use 2 people to place the sit stand on your desk. Be sure that the front edge of the keyboard platform aligns with the desk edge.

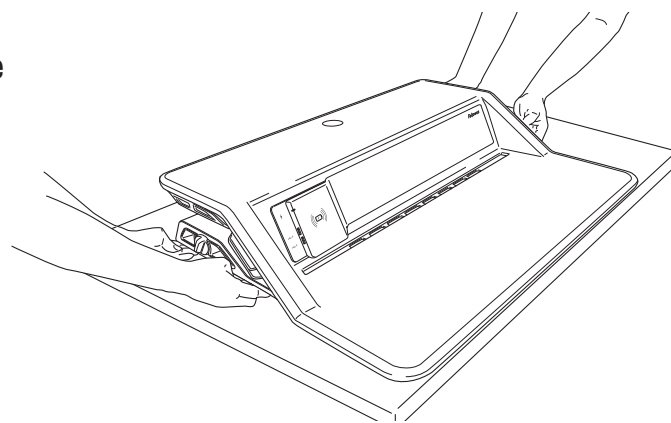
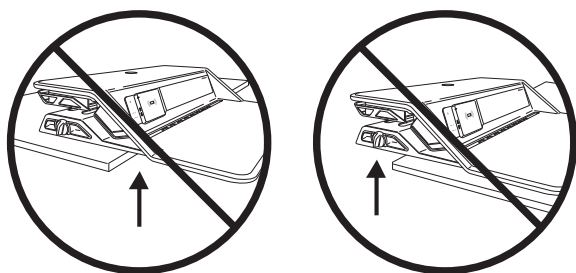

STEP 2

Place your monitor, keyboard and mouse on the workstation. Use the enclosed Velcro to secure the monitor(s) to the workstation. Leave the monitor cover plate in place unless using the Fellowes Monitor Arm Kit for Lotus.

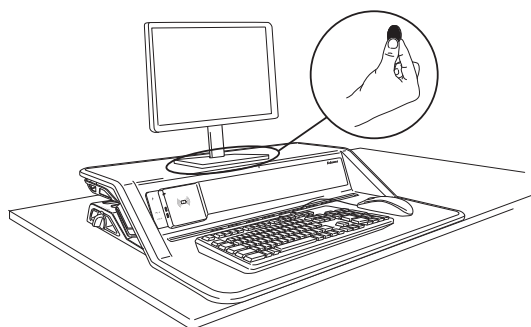

STEP 3

Using both hands, push down slightly and engage both levers to raise the workstation to the highest position.

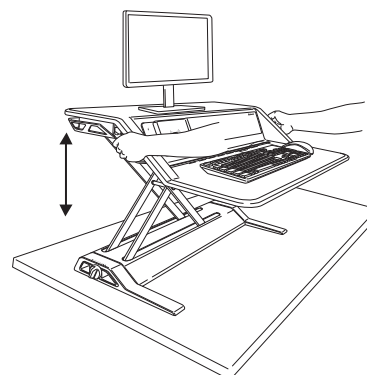

CORD MANAGEMENT

Ensure the workstation is at the highest position. Follow all cord routing instructions to ensure cables are not pinched by the support bars. Make sure the cables are long enough to accommodate the full range of motion (17"/432mm).

STEP 1

Setup the charging stations by connecting the power cord to the power supply and the power supply to the rear USB hub port 2. Plug the power cord into the nearest outlet. In order to use USB ports 3 and 4 for your mouse and keyboard, you will need to plug the provided Type B/USB cord into port 1 and the USB end into your computer, docking station or monitor*.

*Monitor needs to be connected to computer via additional Type B/USB cord (not included).

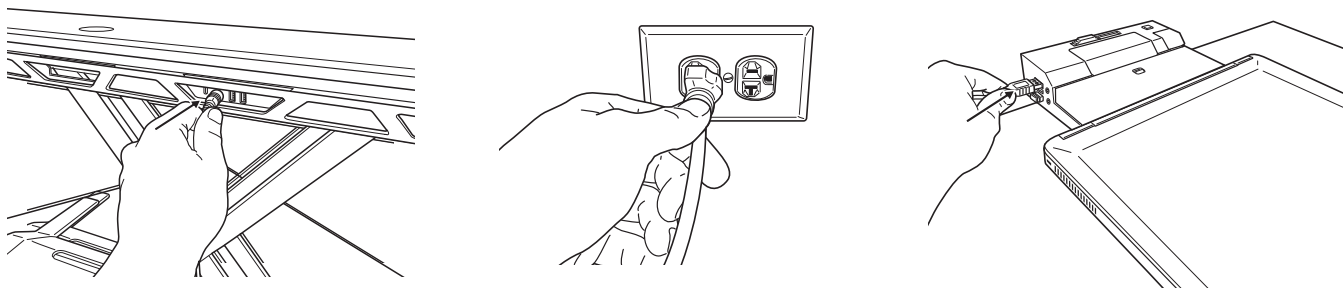

STEP 2A

Route the keyboard and mouse cords through the opening in the keyboard platform. Be sure to anchor the cords with the clip on the underside of the platform. Failure to follow these instructions may result in equipment damage or personal injury.

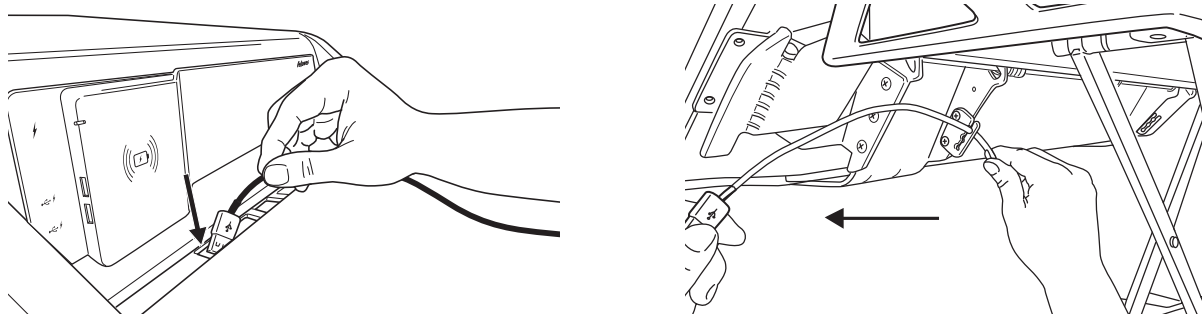

STEP 2B

Continue routing the cords around the workstation through the cord channel to the rear. Insert the cord funnel in 1 of 2 locations on the cord channel. Choose the location that will best accommodate your setup.

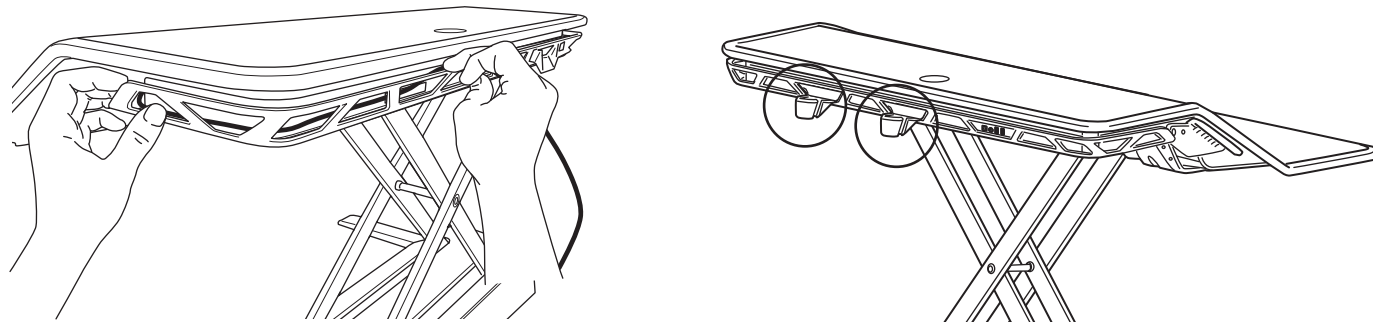

STEP 2C

The rear USB ports are meant for data transfer devices. Plug your mouse and keyboard into the rear USB hub and route the remaining cords through the cord funnel.

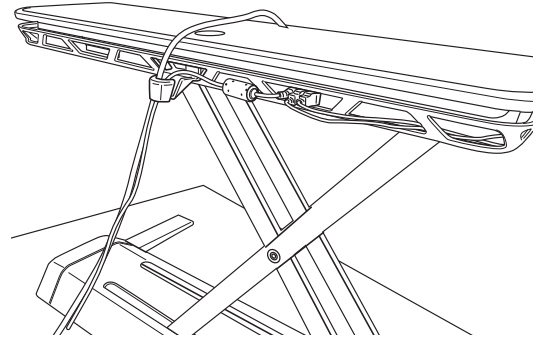

STEP 3

Gather all cords, including the monitor cords. Apply the cable zip using the provided tool.

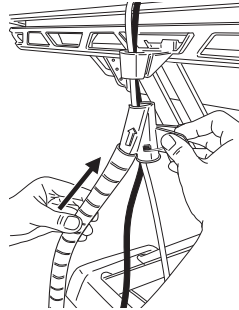
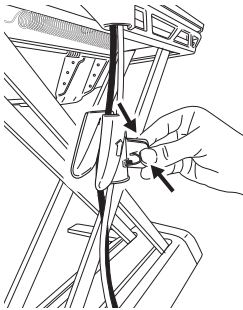

Push the Cable Zip upward into the Cable Zip Tool.

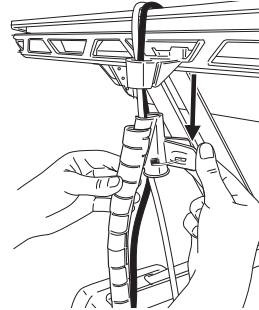

Pull down on the Cable Zip tool while holding the top of the Cable Zip.

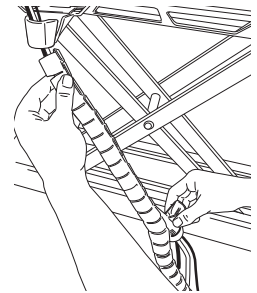

STEP 4

Slide the end of the cable zip into the cord funnel to lock into place.

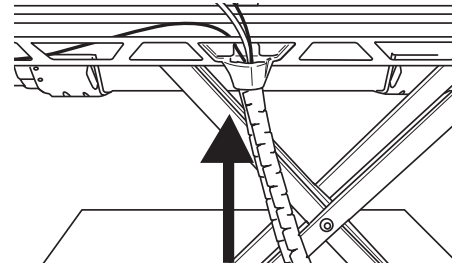

TENSION ADJUSTMENT

Patent pending Smooth Lift Technology™ makes it effortless to raise and lower your sit-stand. Place items onto the workstation and raise up to the highest position. Lotus is shipped at the lowest setting which will help offset 10lbs/4.5kg. Turn the knob clockwise to offset heavier weights, up to 29 full rotations to offset 35lbs/15.8kg. As a guideline, approximately 10 full rotations are needed to offset a dual monitor setup. The exact number of rotations depends on your personal comfort. Once you have properly adjusted the Lotus, it should feel effortless to raise and lower.

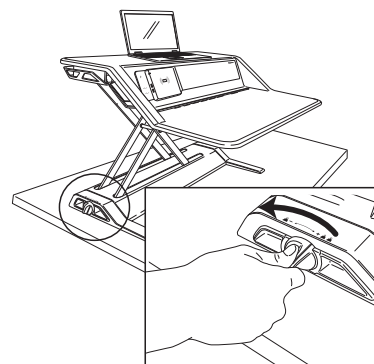
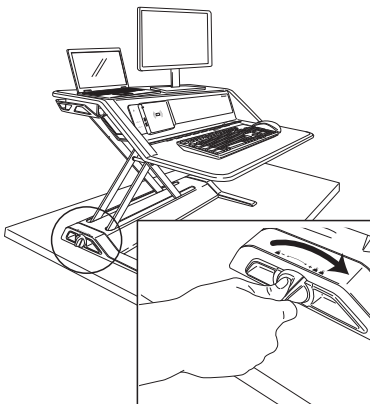

DEVICE STAND/CHARGING SLOT

Place your Qi-enabled device onto the charging pad (image 1) or use USB ports 5 and 6 (image 2) to charge your device. Review your devices manual to see if it's Qi-enabled.

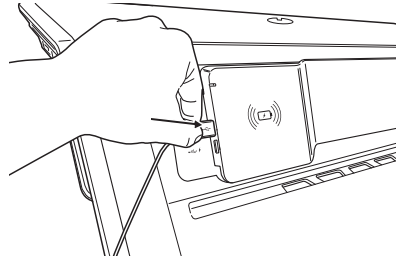
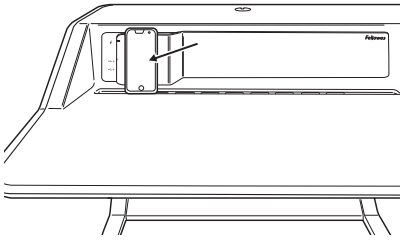

| | White LED |
|-----------------------|-----------|
| Standby | Off |
| Charging | On |
| Device not compatible | Flash |

USAGE GUIDELINES

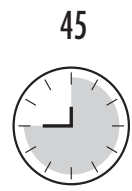
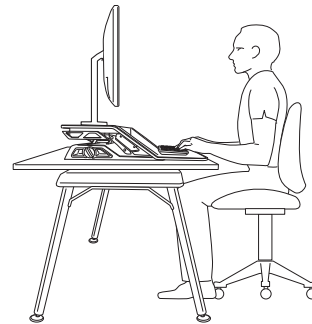
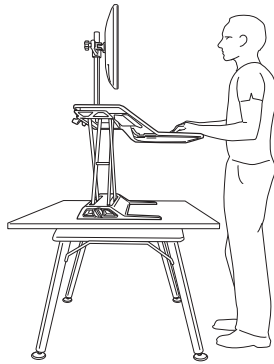

FELLOWES LOTUS™ DX SIT-STAND LIMITED WARRANTY

Fellowes, Inc. ("Fellowes") warrants the Lotus™ DX ("Product") to be free from defects in material and workmanship for the time period as set forth below.

- All of the USB and wireless charging components for a period of one (1) year from the date of original purchase of the product.
- All other parts for a period of three (3) years from the date of original purchase of the product.

This warranty applies only to the initial retail purchaser and does not cover claims resulting from misuse, failure to follow instructions on installation and use, neglect, use of unauthorized attachments, commercial use, use on a current or voltage other than specified on the product, or unauthorized service during the warranty period on conditions otherwise covered by warranty.

THE DURATION OF ANY IMPLIED WARRANTIES, INCLUDING BUT NOT LIMITED TO ANY IMPLIED WARRANTIES OF MERCHANTABILITY OR FITNESS FOR A PARTICULAR PURPOSE, IS EXPRESSLY LIMITED TO THE DURATION OF THIS LIMITED WARRANTY.

UNLESS REQUIRED BY APPLICABLE LAW, THE CUSTOMER'S EXCLUSIVE REMEDY FOR BREACH OF THIS WARRANTY OR ANY IMPLIED WARRANTY OR OF ANY OTHER OBLIGATION ARISING BY OPERATION OF LAW OR OTHERWISE SHALL BE LIMITED AS SPECIFIED HEREIN TO REPAIR, REPLACEMENT OR A REFUND OF THE PURCHASE PRICE, AT THE COMPANY'S SOLE OPTION.

UNDER NO CIRCUMSTANCE WILL THE COMPANY, ITS AFFILIATES, SUBSIDIARIES, RELATED ENTITIES, RESELLERS OR THEIR RESPECTIVE OFFICERS, DIRECTORS OR EMPLOYEES OR THOSE PERSONS FOR WHOM THEY ARE BY LAW RESPONSIBLE, BE LIABLE FOR CONSEQUENTIAL OR INCIDENTAL DAMAGES SUBSTAINED IN CONNECTION WITH THE PRODUCT. THE COMPANY AND THESE OTHER PARTIES DO NOT ASSUME OR AUTHORIZE ANY REPRESENTATIVE OR OTHER PERSON TO ASSUME FOR ANY OF THEM ANY OBLIGATION OR LIABILITY OTHER THAN AS IS EXPRESSLY SET FORTH HEREIN.

The duration, terms and conditions of this warranty are valid worldwide, except where different limitations, restrictions or conditions may be required by local law.

Fellowes Lotus™ DX contain built in biocidal products for the protection against the growth of bacteria which cause stains and product deterioration.

The treated article contains the following biocide:

- Glass, oxide, silver phosphate

Australia Residents Only:

Our goods come with guarantees that cannot be excluded under the Australian Consumer Law. You are entitled to a replacement or refund for a major failure and for compensation for any other reasonably foreseeable loss or damage. You are also entitled to have the goods repaired or replaced if the goods fail to be of acceptable quality and the failure does not amount to a major failure. The benefits under Fellowes' Warranty are in addition to other rights and remedies under a law in relation to the product.



CUSTOMER SERVICE & SUPPORT

www.fellowes.com

Europe Freephone: 00800-1810-1810

Benelux: +31-(0)-13-458-0580

Deutschland: +49 (0)511 545489-0

France: +33 (0) 1 78 64 91 00

Italia: +39-071-730041

Polska: +48 (22) 205-21-10

España/Portugal: +34-91-748-05-01

United Kingdom: +44 (0) 1302 836836

Australia: 1800 33 11 77

Declaration of Conformity

Fellowes, Inc.

Unit 2 Ontario Drive, New Rossington, Doncaster, DN11 0BF, England declares that the product model Lotus™ DX Sit-Stand Workstation conforms with the requirements of the Restriction of Hazardous Substances Directive (2011/65/EU), the Electromagnetic Compatibility Directive (2014/30/EU), the WEEE directive (2012/19/EU), and below harmonized European EN Standards.

EMC: EN 55032:2015
EN 55024:2010/A1:2015
EN 61000-3-2:2014
EN 61000-3-3:2013

Year Affixed: 17

Itasca, Illinois, USA
August 1, 2017

John Fellowes

W.E.E.E.

This product is classified as Electrical and Electronic Equipment. Should the time come for you to dispose of this product please ensure that you do so in accordance with the European Waste of Electrical and Electronic Equipment (WEEE) Directive and in compliance with local laws relating to this directive.

For more information on the WEEE Directive please visit www.fellowes.com/WEEE

Fellowes
Brands™

1789 Norwood Avenue, Itasca, Illinois 60143 • 1-800-955-0959 • www.fellowes.com